

CERTIFIED CORNER RECORDATION

Corner 1/4 Sec. 18 & 17 T. 30N R. 31W P.M., MT Lincoln County

I. 1893 G.L.O. Original Record by Daniel P. Mumbrue: Set a wooden post, 3 ft. long, 3 ins. square, 24 ins. in the ground, for 1/4 sec. cor., mkd. "1/4 S" on the W. face. Set two bearing trees.

1962 B.L.M. Remonumentation Record by Gerald F. Pittman et. al.: The 1/4 sec. cor. of secs. 17 and 18, monumented by a wooden post, 3 ft. long, 3 ins. square, set and mkd. as described in the official record and witnessed by the two original bearing trees.

from which:

A pine, 19 ins. diam., bears N08 1/2°E, 8 lks. dist., mkd. "X 1/4 S BT". (record-mkd. "1/4 S BT")
A fir, 20 ins. diam., bears N89 1/2°W, 10 lks. dist., mkd. "XX 1/4 S BT". (record-mkd. "1/4 S BT")

At the corner position, set an iron post, 30 ins. long, 2 1/2 ins. diam., 26 ins. in the ground, with brass cap mkd. as shown:

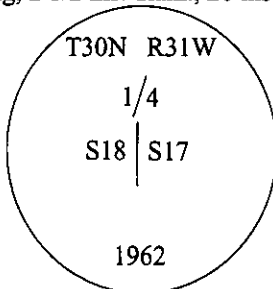

1973 B.L.M. Dependent Resurvey by Shirley B. Hjellum et al.: The 1/4 sec. cor. of secs. 17 & 28, monumented with an iron post, 2 1/2 ins. in diam., protruding 8 ins. above the ground, firmly set and witnessed by the original bearing trees, mkd. as described in the official record, in good condition.

1986 Certified Corner Recordation by Harold W. Grusing No. 2925 S. Found a 2 1/2 in. diam. iron post, protruding 6 ins. above the ground, witnessed by the original bearing trees, mkd. as described in the official record, in good condition, with the brass cap mkd. as shown above.

II. Found a 3 in. diam. aluminum pipe, protruding 10 ins. above the ground, firmly set, with a 3 1/4 in. diam. brass cap mkd. as shown above.

from which:

A pine, 21 ins. diam., bears N08°E, 5.3 ft. dist., mkd. with visible scribe. (record N08 1/2°E, 8 lks. "5.2 ft.")
A fallen fir, 23 ins. diam., bears N88°W, 6.4 ft. dist., with no visible scribe. (record N89 1/2°W, 10 lks. 6.6 ft.)

III. Established two new bearing trees:

A fir, 23 ins. diam., bears S04°E, 63.9 ft. dist., mkd. "1/4 S17 BT".
A fir, 25 ins. diam., bears South, 104.2 ft. dist., mkd. "1/4 S18 BT".

Painted bearing trees and attached Land Survey Monument and Bearing Tree signs.

Magnetic Declination: 20° East.

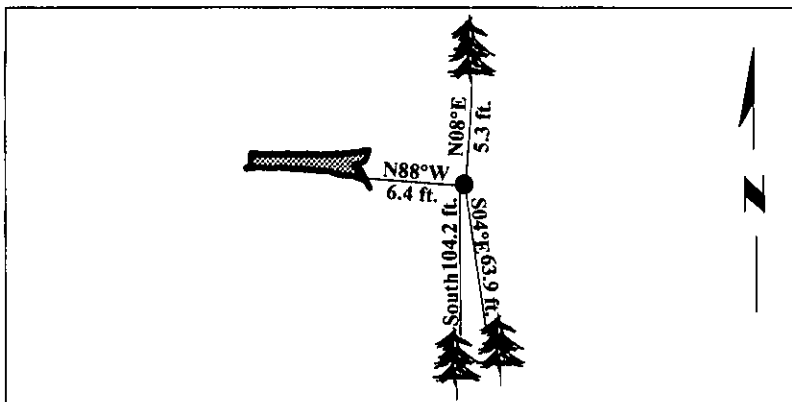
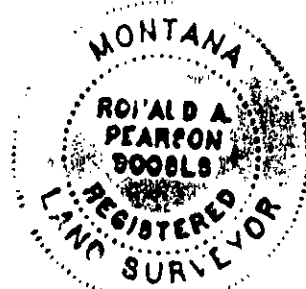

SKETCH OF CORNER

CERTIFICATION

I, Rex O. Rice
certify the information shown herein is true and correct.

I, Ronald A. Pearson
certify that this Corner Record correctly represents work performed by me or under my direction in compliance with the "Corner Recordation Act" (70-22-101, et seq., M.C.A.)

Signature of Surveyor & Seal

Date: 12/30/96

Reg. No.: 9008LS

Employer: U.S. FOREST SERVICE

Office of Clerk and Recorder, County of LINCOLN This "corner record" was filed for record on FEB 3, 1997 was noted on the cross-index plat and is assigned page No. 9025, in book No. _____

CORAL M. CUMMINGS
County Official

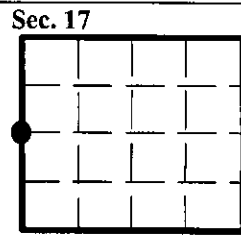

● - corner this sheet