

CERTIFIED LAND CORNER RECORDATION

DESCRIPTION OF CORNER EVIDENCE FOUND, AND ORIGINAL RECORD (IF KNOWN)

This Section corner common to Sections 22, 23, 26 and 27 of Township 30 North, Range 31 West of the M.P.M. Lincoln County, Montana was relocated by the Bureau of Land Management with a 1" x 6' pipe with a brass cap in one end on top. The brass cap was in the road and with road construction the brass cap was pulled away from the pipe which still is below the surface of the road level approximately 6 inches.

DESCRIPTION OF MONUMENT AND ACCESSORIES ESTABLISHED TO PERPETUATE THE ORIGINAL LOCATION OF THIS CORNER:

Date of work: May 20th.
1967

From the one inch by six foot pipe which is in the ground for the common corner to Sections 22, 23, 26 and 27 of Township 30 North, Range 31 West of the M.P.M. Lincoln County, Montana bears a B.T. 9" Pine South 23° 00' West a distance of 71.95 feet. A red head in a power pole which bears North 37° 35' East a distance of 35.38 feet and a steel rebar 5/8 inch by 24 inches driven flush with the ground bears North 0° 02' West a distance of 30.00 feet from the afore said Section Corner.

SKETCH, WITH COURSE AND DISTANCE TO ADJACENT CORNERS IF DETERMINED IN THIS SURVEY. (MAY SKETCH OR PASTE REPRODUCTION ON REVERSE SIDE.)

Sec. 23, T. 30N. , R. 31 W.

22	23	N. 89° 56' E. - 2618.12'	South N 1/4 Cor.
27	26	WWW	

Surveyor's Seal

I, _____
certify that the information shown herein is true and correct.

Signature of Ground Party Chief

I, Donald D. Dahl
certify that I have carefully performed or reviewed the work done on the diagrammed corner as reported on this recordation form and approve the same.

Donald D. Dahl
Signature of Surveyor

798-S.

Registration Number

DIAGRAM OF CORNER:

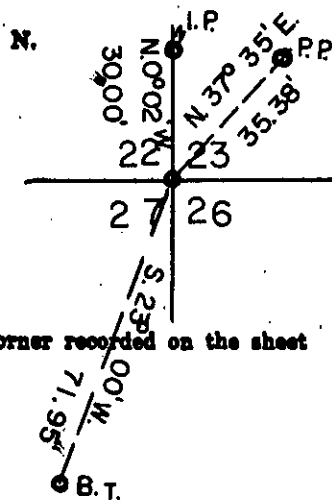

Office of Clerk and Recorder, County of Lincoln County, State of Montana

This "corner record" was filed for record on the 5th day of October 1967, was noted on the cross-index plat and is assigned page No. 81, in book No. 1

Eleanor L. Vaughn By Gene Walters
County Official Deputy

781

STATE OF MONTANA
COUNTY OF LINCOLN

Filed this 5th day of

October A. D. 1967

at 3:45 P. M.

Eleanor P. Hargrave

County Clerk

By Sam Watson Deputy

