

CERTIFIED LAND CORNER RECORDATION

DESCRIPTION OF CORNER EVIDENCE FOUND, AND ORIGINAL RECORD (IF KNOWN)

DESCRIPTION OF MONUMENT AND ACCESSORIES ESTABLISHED
TO PERPETUATE THE ORIGINAL LOCATION OF THIS CORNER:

Date of work:.....
July 9, 1963

SKETCH, WITH COURSE AND DISTANCE TO ADJACENT CORNERS IF DETERMINED IN THIS SURVEY.
(MAY SKETCH OR PASTE REPRODUCTION ON REVERSE SIDE.)

Set steel pin from which the 8" trunk of
Pine (school marm) bears S 58½E 2½ feet
marked P B 3

Set steel pin from which 8" Aspen bears
N65 E 8½ feet marked P B #2

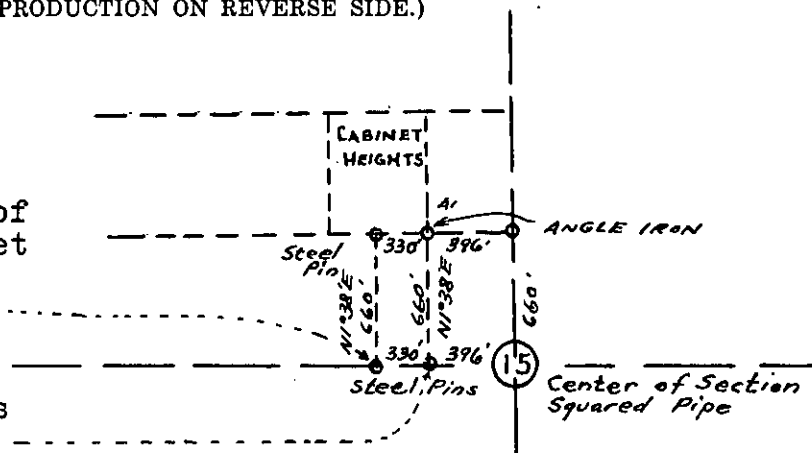

DIAGRAM OF CORNER:

Surveyor's Seal

I, Jack Ninneman
certify that the information shown herein is true and
correct.

N.

Jack Ninneman
Signature of Ground Party Chief

I, Jack Ninneman
certify that I have carefully performed or reviewed the
work done on the diagrammed corner as reported on this
recordation form and approve the same.

Jack Ninneman
Signature of Surveyor

L-15 = Corner recorded on the sheet

534 E.S.
Registration Number

Office of Clerk and Recorder, County of Lincoln

This "corner record" was filed for record on the 14th day of October 1963, was noted on the cross-index plat and is
assigned page No. 3, in book No. 1

M. M. MANSEFIELD
County Official

Wm Watson
Deputy

STATE OF MONTANA
COUNTY OF LINCOLN

Filed this 14th day of October A. D. 1903

at 1:40 P. M.
Wm. H. Ward Clerk
J. M. Ward Deputy Clerk