

CERTIFIED LAND CORNER RECORDATION

Sec. 9 Twp. 30 N., R. 31 W., M.P.M.

DESCRIPTION OF CORNER EVIDENCE FOUND, AND ORIGINAL RECORD (IF KNOWN)

THESE CORNERS NOT PREVIOUSLY SET

Corners 2, 3, 4, and 5

DESCRIPTION OF MONUMENT AND ACCESSORIES ESTABLISHED TO PERPETUATE THE ORIGINAL LOCATION OF THIS CORNER:

Date of work: 4/6/70

SEE PLAT ATTACHED

SKETCH, WITH COURSE AND DISTANCE TO ADJACENT CORNERS IF DETERMINED IN THIS SURVEY. (MAY SKETCH OR PASTE REPRODUCTION ON REVERSE SIDE.)

SEE PLAT ATTACHED

Surveyor's Seal

Jack H. Ninneman

I, ... certify that the information shown herein is true and correct.

Signature of Jack H. Ninneman

Signature of Ground Party Chief

Jack W. Ninneman

I, ... certify that I have carefully performed or reviewed the work done on the diagrammed corner as reported on this recordation form and approve the same.

Signature of Jack W. Ninneman

Signature of Surveyor

354 ES

Registration Number

DIAGRAM OF CORNER:

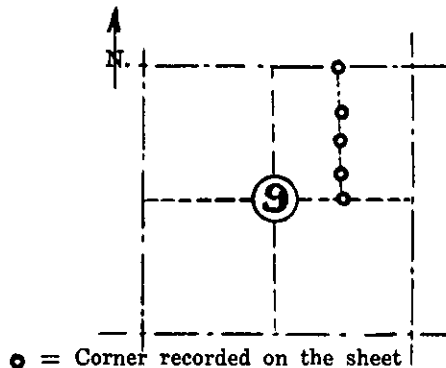

Office of Clerk and Recorder, County of Lincoln

This "corner record" was filed for record on the 25th day of May 1970, was noted on the cross-index plat and is assigned page No. 205, in book No. 1

ELEANOR L. VAUGHN, By: Mae Watson Deputy County Official

DESCRIPTION

Sec. 9 Twp. 30 N., R. 31 W., M.P.M.

- #1. Steel Pin Set and Recorded Previously
- #2. Set Steel Pin and Location Poster
- #3. Set Steel Pin From Which a 10" Fir Bears S 73°13'W 7.8 Feet
and a 10" Fir Bears N 71°42'E 8.4 Feet
Both Trees Scribed N 1/16 E and Posted
- #4. Set a Steel Pin and Location Poster
- #5. "Lifetime" Plastic Monument

