

CERTIFIED LAND CORNER RECORDATION

Section 23 Twp. 30 N., R. 31 W., M.P.M.

DESCRIPTION OF CORNER EVIDENCE FOUND, AND ORIGINAL RECORD (IF KNOWN)

N 1/4 "T" Bar By Others
C 1/16 Never Set
C 1/4 Brass Cap In Concrete Posted By DAHL

DESCRIPTION OF MONUMENT AND ACCESSORIES ESTABLISHED
TO PERPETUATE THE ORIGINAL LOCATION OF THIS CORNER:

Date of work: 4/16/'70

SEE ATTACHED PLAT

SKETCH, WITH COURSE AND DISTANCE TO ADJACENT CORNERS IF DETERMINED IN THIS SURVEY.
(MAY SKETCH OR PASTE REPRODUCTION ON REVERSE SIDE.)

SEE ATTACHED PLAT

Surveyor's Seal

I, Jack H. Ninneman
certify that the information shown herein is true and correct.

Jack H. Ninneman
Signature of Ground Party Chief

I, Jack W. Ninneman
certify that I have carefully performed or reviewed the work done on the diagrammed corner as reported on this recordation form and approve the same.

Jack W. Ninneman
Signature of Surveyor

DIAGRAM OF CORNER:

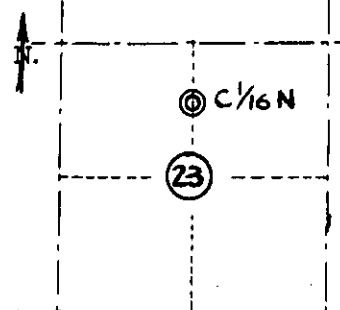

⊙ = Corner recorded on the sheet

354 ES
Registration Number

Office of Clerk and Recorder, County of Lincoln

This "corner record" was filed for record on the 25th day of May 1970, was noted on the cross-index plat and is assigned page No. 202-A, in book No. 1

ELEANOR L. VAUGHN, By: *Max Watson*
County Official Deputy.

DESCRIPTION

Sec. 23 Twp. 30 N., R. 31 W., M.P.M. Monuments and Accessories

- N 1/4 Found "T" Bar Set by Others
- C 1/16 N Set a 1" Pipe 42" Long in a mound of Stones Aprox. 1 1/2 Ft. Above the Ground From Which an 18" Spruce Bears N 14° 30' W 102.2 Feet
- An 18" Cottonwood Bears S 87° W 113.2 Feet
- Both Trees Scribed C 1/16 N and Posted
- C 1/4 Brass Cap in Concrete Post Set and Recorded in Courthouse by DAHL

