

CERTIFIED CORNER RECORDATION

CORNER E1/4 T. 30 N., R. 31 W., P.M.M. LINCOLN COUNTY

RECORD:

Per GLO records of Daniel Mumbrue of 1893 Contract No. 287

Set a 3 ft post, 3 ins. dia., 24 ins. in the ground, marked 1-4 S. on the west face.

From Which

A Tamarack, 12 ins. dia., bears S11 3/4°E, 20 lks. dis., amrked 1/4 S BT.

A Pine, 14 ins. dia. bears N88°W, 13 lks dist., marked 1/4 S BT.

Remonumented by BLM Group No. 517, Montana, in 1962-64

Monumented with an Iron Post, not of record, 2 1/2 ins. diam., firmly set, projecting 6 ins., above ground, in a collar of stone, with Brass Cap (see diagram below)

From which

A Pine, 19 ins. diam., bears N. 351/2°E., 58 lks. dist., with partially healed blaze.

A Pine, 18 ins. diam., bears N 771/2°W., 44 lks. dist., with partially healed blaze.

FOUND EVIDENCE:

3 1/4 inch Brass Cap stamped by Bur. of Land Management

A 16 inch dia. dead Pine with visible scribing bears N39°E, 37.8 ft dist.

PERPETUATION:

A 8 inch dia. Pine scribed T30N R31W S 26 BT. bears S29.5°E, 15.3 ft dist.

A 4 inch dia. fence post without markings bears S88.5°W, 1.65 ft dist.

MAGNETIC DECLINATION: 18° E

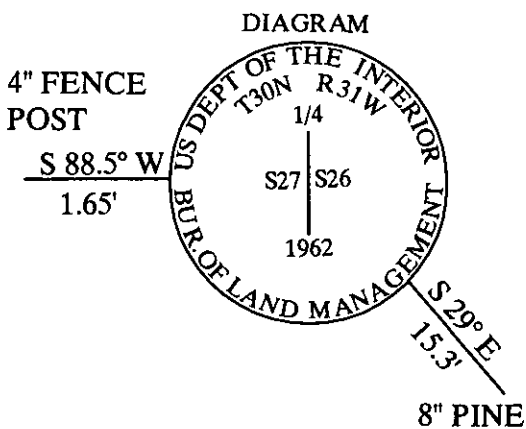

CERTIFICATION

I, Alan William
 Certify the information shown herein is true and correct
 Signature of Ground Party Chief

I, [Signature]
 certify that this Corner Record correctly represents work performed by me, or under my direction in compliance with the "Corner Recordation Act" (70-2-101 M.S.P.A.)

[Signature]
 Signature of Surveyor & Seal
 Date: 10/31/08 Reg. No. 1975-S
 Employer: DAVIS Surveying Inc

SKETCH OF CORNER

Office of Clerk and Recorder, County of
 This "corn 212334 BOOK: CCR CC&R'S PAGE: 11221 Pages: 1
 was noted STATE OF MONTANA LINCOLN COUNTY
 No. _____ RECORDED: '06/23/2008 3:35 KOI: CC&R'S
 In book No. _____ TAMMY D. LAUER CLERK AND RECORDER
 FEE: \$0.00 BY: [Signature]
 TO: DAVIS SURVEYING, INC. P.O. BOX 896, TROY, MONTANA 59935

SECTION

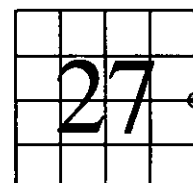

Cross Index No. W1/4 T. 30 N., R. 31 W., P.M.M.

THIS CORNER