

## INSTRUCTIONS

1. Original and/or subsequent record used to evaluate the corner position.
2. Description of evidence found, note discrepancies in the record, state method of establishing lost or obliterated corners.
3. Description of monument and accessories set to perpetuate the corner position.
4. Sketch of corner, show all pertinent data which can best be shown in a sketch example, corner marking, topography ties, position of accessories, etc.
5. Certification must be signed and sealed by Land Surveyor registered in the State of Montana.
6. Fill in Cross Index & Section Diagram at bottom of sheet.

## CERTIFIED CORNER RECORDATION

Corner NE1/16 Sec. 11 T. 30N R. 31W P.M.M. Lincoln County

## CORNER RECORD: BLM - 1973

Set an iron post, 28" long, 2½" diameter, 24" in the ground, with brass cap, marked as shown below; from which:

A Larch, 10" diameter, bears N77½°E, 27 links (17.82 feet) distant, marked "T30N R31W NE1/16 S11 BT"

A Fir, 11" diameter, bears S9¼°W, 16 links (10.56 feet) distant, marked "T30N R31W NE1/16 S11 BT"

## FOUND:

Found a ¾" brass cap on 2½" iron pipe marked as shown below. Monument is 0.1' above ground with a U.S. Forest Service post 3.6' west of corner monument.

Found a 13" Tamarack, with healed blaze and a bearing tree tag (marked S79°W, 18.2 feet distant), bears N77½°E, 18.3 feet distant

Found a 16" Douglas Fir, with healed blaze and a bearing tree tag (marked N9°E, 10.4 feet distant), bears S9°W, 10.2 feet distant.

Bearing tree tags were attached and blazes painted red.

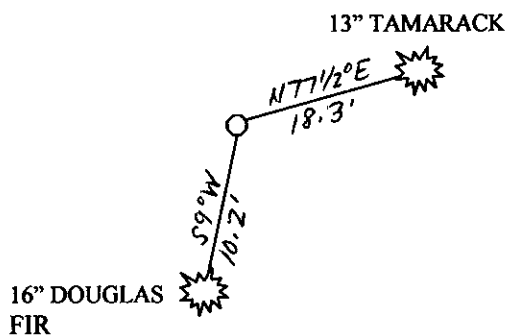
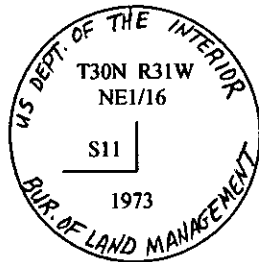

SKETCH OF CORNER

## CERTIFICATION

I, James R. Staples

Certify the information shown herein is true and correct.

James R. Staples  
Signature Ground Party Chief

I, James R. Staples

certify that this Corner Record correctly represents work performed by me or under my direction in compliance with the "Corner Record Act" (70-22-101, et seq., M.C.A.)

James R. Staples  
Signature of Surveyor & Seal

Date: 10/18/07 Reg. No. 9958 LS

Employer: J.R.S. Surveying, Inc.

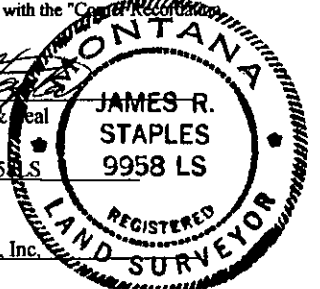

Office of Clerk and Recorder, County of \_\_\_\_\_ This "corner

record" was filed for record

was noted on the cross-index

book no. \_\_\_\_\_

206785 BOOK: CCR CC&R'S PAGE: 11155 Pages: 1

STATE OF MONTANA LINCOLN COUNTY

RECORDED: 10/16/2007 9:36 KOI: CC&R'S

TAMMY D. LAUER CLERK AND RECORDER

FEE: \$0.00

BY: James R. Staples

TO: J.R.S. SURVEYING P.O. BOX 1050, LIBBY, MONTANA 59923

County Official

Cross Index No. F20 T. 30N R. 31W PMM

Adopted July 1, 1981, Montana Board of Professional Engineers & Land Surveyors

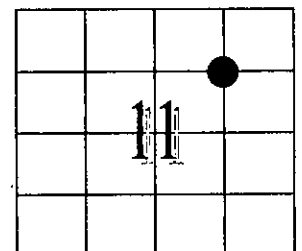

• - Corner this sheet