

INSTRUCTIONS

1. Original and/or subsequent record used to evaluate the corner position.
2. Description of evidence found, note discrepancies in the record, state method of establishing lost or obliterated corners.
3. Description of monument and accessories set to perpetuate the corner position.
4. Sketch of corner, show all pertinent data which can best be shown in a sketch example, corner marking, topography ties, position of accessories, etc.
5. Certification must be signed and sealed by Land Surveyor registered in the State of Montana.
6. Fill in Cross Index & Section Diagram at bottom of sheet.

**CERTIFIED CORNER RECORDATION**

Corner Northeast Closing Corner Sec. 17 T. 30 N. R. 30 W. P.M.M. Lincoln County

- I. 1904 G.L.O. original record by G. W. Pessenden and R. G. Lyman. Subdivision of Fractional T30N., R30W.:  
 Notes read: "Fall 110 lks. N. 89° 47' W. of cor. established for secs. 8, 9, 16 and 17, which is a stone 12X9X6 ins. above ground marked and witnessed as described by the Surveyor General. This cor. will hereafter refer to secs. 8 and 9 only. I therefore efface the marks on bearing trees in secs. 16 and 17. At the point of intersection I set a slate stone 12X10X6 ins. 8 ins. in the ground for closing cor. of secs. 16 and 17. marked C.C. on the S. with 4 grooves on E. and 2 grooves on W. face,"  
 from which  
 A fir 4 ins. dia. bears S. 57° W. 3 lks. dist., marked T 30 N R 30 W S 17 BT  
 A fir 9 ins. dia. bears S. 22° E. 73 lks. dist., marked T 30 N R 30 W S 16 BT
- II. Found, 4 pieces of a slate stone, scattered in a radius of 3 ft. One piece marked with a X and 4 grooves and a large piece was found with 3 grooves lying on its side downhill of an indentation in the ground. Indentation of ground bears N 86° W 71.0 ft. (107 lks) dist., from corner for Sec. 8 and 9. The pieces of stone shown evidence of fracture due to heat of the 1910 fire. From indentation of ground I rotated the bearings to the record bearing trees 3° clockwise and found  
 A fir root wade bears S. 57° W. 2.0 ft. (31 lks) dist. 4 ins. below surface.  
 A fir root wade 10 ins. dia. bears S. 20° W. 48.2 ft. (73 lks) dist. 4 ins. below surface.
- III. At a distance distance intersect of the found original Bt's, which is same as indentation in ground, I set a 2 1/2 in. dia. by 30 ins. long aluminum pipe. 26 ins. in the ground with a 3 1/4 in. dia. U.S.D.A., Forest Service, aluminum cap marked as shown:

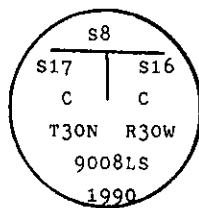

Established two new bearing trees:

- A fir 9 in. dia. bears S. 78° E., 20.6 ft. dist. mkd. T 30 N R 30 W S 16 BT.
- A fir 13 in. dia. bears S. 2° W., 22.8 ft. dist. mkd. T 30 N R 30 W S 17 BT.

Painted a red band around each bearing tree and attached "Land Survey Monument" and "Bearing Tree" signs where needed. Bury original stone alongside the Monument. Magnetic Declination: 21° 30' East.

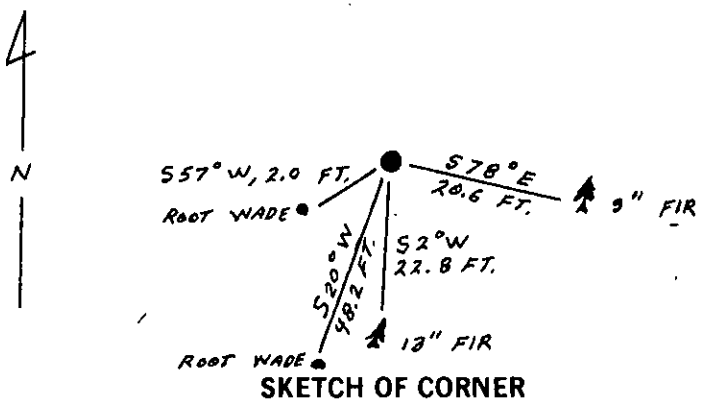
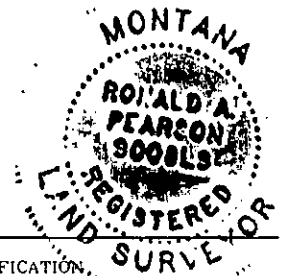

CERTIFICATION  
 Ronald A. Pearson  
 I, \_\_\_\_\_  
 certify the information shown herein is true and correct.  
 Signature Ground Party Chief  
 Ronald A. Pearson  
 I, \_\_\_\_\_  
 certify that this Corner Record correctly represents work performed by me or under my direction in compliance with the "Corner Recordation Act" (70-22-101, et seq., M.C.A.)  
 Signature of Surveyor & Seal  
 Date: 6/6/90 Reg. No. 9008LS  
 Employer: U.S. FOREST SERVICE

Office of Clerk and Recorder, County of Lincoln. This "corner record" was filed for record on Aug 6, 1990 was noted on the cross-index plat and is assigned page No. 4276, in book No. \_\_\_\_\_  
Janet BF Sugit by Eric Buckell  
 County Official

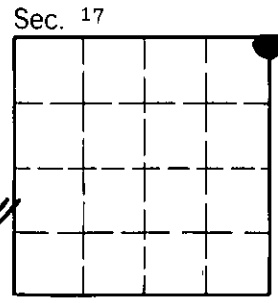

J-9 Cross Index No. \_\_\_\_\_ T. \_\_\_\_\_ R. \_\_\_\_\_ P.M.M.