

CERTIFIED LAND CORNER RECORDATION
(REFERENCE FSM 7153.53)

DESCRIPTION OF CORNER EVIDENCE FOUND, AND ORIGINAL RECORD (IF KNOWN)

Iron post, firmly set, with B.L.M. brass cap, marked as shown:
from which; A pine, 18 ins. dia, bears N72°30'W, 22 lks, alive (record)
A fir, 6 ins. dia, bears S23°W, 61 lks. (record)

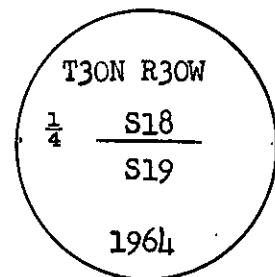

DESCRIPTION OF MONUMENT AND ACCESSORIES ESTABLISHED
TO PERPETUATE THE ORIGINAL LOCATION OF THIS CORNER:

Date of work: 1979

Placed National Forest Property post beside corner
Blazed line north to C 1/4

SKETCH, WITH COURSE AND DISTANCE TO ADJACENT CORNERS IF DETERMINED IN THIS SURVEY.
(MAY SKETCH OR PASTE REPRODUCTION ON REVERSE SIDE.)

See Certificate of Survey No. 751

Surveyor's Seal

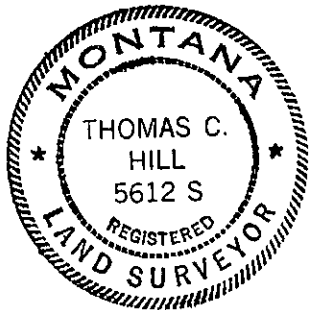

I, Gary C. Crismon, certify that the information shown herein is true and correct.

Signature of Gary C. Crismon
Signature of Ground Party Chief

I, Thomas C. Hill, certify that I have carefully performed or reviewed the work done on the diagrammed corner as reported on this recordation form and approve the same.

Signature of Thomas C. Hill
Signature of Surveyor

DIAGRAM OF CORNER:

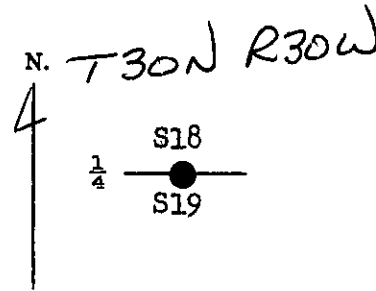

● = Corner recorded on the sheet

5612-S
Registration Number

Office of Clerk and Recorder, County of Lincoln

This "corner record" was filed for record on the 2nd day of March, 1980, was noted on the cross-index plat and is assigned page No. 661, in book No. 1

Signature of County Official
County Official

Cross Index No. N3 T. 30 R. 30 Mer.