

INSTRUCTIONS

1. Original and/or subsequent record used to evaluate the corner position.
2. Description of evidence found, note discrepancies in the record, state method of establishing lost or obliterated corners.
3. Description of monument and accessories set to perpetuate the corner position.
4. Sketch of corner, show all pertinent data which can best be shown in a sketch example, corner marking, topography ties, position of accessories, etc.
5. Certification must be signed and sealed by Land Surveyor registered in the State of Montana.
6. Fill in Cross Index & Section Diagram at bottom of sheet.

CERTIFIED CORNER RECORDATION

Corner Amended R/W Monument East of NW Sec. 4 30 N. 30 W. P.M.M. Lincoln County

I. 1989 Corner Recordation by A. Hughes, 7322-LS

II. Found a 3/4 in. diam. aluminum rod with a 3 1/4 in. U.S.D.A aluminum cap, marked as shown, from which 2 bearing trees as per record.

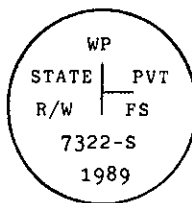

III I amend the position of this corner as the NW Section Corner Section 4 was erroneously double proportioned. See Amended Certificate of Survey for Section 4. The new corner position bears N00°56'25"E, 11.05 ft. from the 1989 Corner position. I use the same bearing trees however bearings and distances are changed. I stamp "93" on the aluminum cap, from which:

A pine, 14 ins. diam., bears S52°E, 44.0 ft. dist., healed face.

A Douglas fir, 8 ins. diam., bears S6°W, 95.2 ft. dist., healed face.

I repainted red bands around the bearing trees. Land Survey Monument and Bearing Tree signs intact.
Magnetic Declination: 20° East

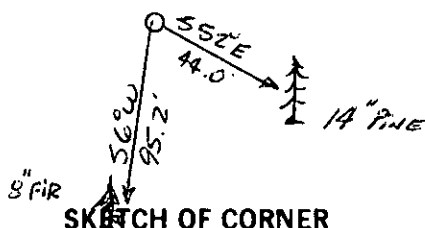

SKETCH OF CORNER

CERTIFICATION

Thomas M. Hommel

I, Thomas M. Hommel, certify the information shown herein is true and correct.

Signature Ground Party Chief

Alvah F. Hughes

I, Alvah F. Hughes, certify that this Corner Record correctly represents work performed by me or under my direction in compliance with the "Corner Recordation Act" (70-22-101, et seq., M.C.A.)

Signature of Surveyor & Seal

Date: 7/07/93 Reg. No. 7322-LS

Employer: U.S. FOREST SERVICE

Office of Clerk and Recorder, County of Lincoln. This "corner record" was filed for record on July 23, 1993 was noted on the cross-index plat and is assigned page No. 5343, in book No. Coral M. Cumming by OB

County Official

Cross Index No. B-9.07 T. 30 N. R. 30 W. PMM

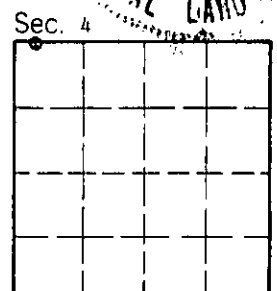

• - corner this sheet