

INSTRUCTIONS

1. Original and/or subsequent record used to evaluate the corner position.
2. Description of evidence found, note discrepancies in the record, state method of establishing lost or obliterated corners.
3. Description of monument and accessories set to perpetuate the corner position.
4. Sketch of corner, show all pertinent data which can best be shown in a sketch example, corner marking, topography ties, position of accessories, etc.
5. Certification must be signed and sealed by Land Surveyor registered in the State of Montana.
6. Fill in Cross Index & Section Diagram at bottom of sheet.

CERTIFIED CORNER RECORDATION

Corner Amended NW1/16 Sec. 4 T. 30 N. R. 30 W. P.M.M. Lincoln County

- I. 1975 Corner Recordation by J. Ninneman, 534 ES.
1989 Corner Recordation by A. Hughes, 7322 LS, Page 4177.
- II. Found a 3/4 in. diam. aluminum rod, flush with the ground, with a 3 1/4 ins. diam. U.S.D.A. brass cap, marked as shown:

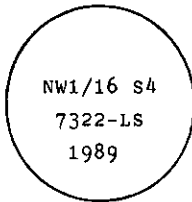

from which:

- A larch, 7 ins. diam., bears $N46^{\circ}52'E$, 26.8 ft. dist., mkd. NW1/16 S4 BT.
- A Douglas fir, 11 ins. diam., bears $N75^{\circ}03'W$, 16.4 ft. dist., with healed face.

- III. I amend the position of this corner as the NW Section Corner Section 4 was erroneously double proportioned. See Amended Certificate of Survey for Section 4. The new corner position bears $N00^{\circ}22'41"E$, 3.05 ft. from the 1989 Corner position. I use the same bearing trees however bearings and distances are changed. I stamp "93" on the aluminum cap, from which:

- A Larch, 7 ins. diam., bears $S52^{\circ}W$, 25.2 ft. dist., mkd. NW1/16 S4 BT.
- A Douglas fir, 11 ins. diam., bears $S87^{\circ}E$, 16.0 ft. dist., with healed face.

I repainted red bands around the bearing trees, with Land Survey Monument and Bearing Tree signs attached.
Magnetic Declination: 20° East

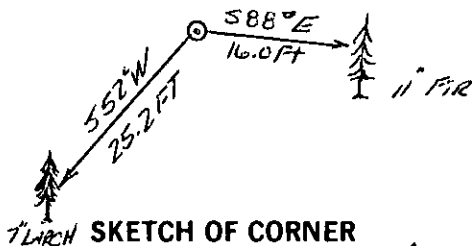

CERTIFICATION

I, Thomas M. Hommel
certify the information shown herein is true and correct.

Thomas M. Hommel
Signature Ground Party Chief

I, Alvah F. Hughes
certify that this Corner Record correctly represents work performed by me or under my direction in compliance with the "Corner Recordation Act" (70-22-101, et seq., M.C.A.)

Alvah F. Hughes
Signature of Surveyor

Date: 7/07/93 Reg. No. 73225

Employer: U.S. FOREST SERVICE

HUGHES
7322 LS

Office of Clerk and Recorder, County of Lincoln. This "corner record" was filed for record on July 23, 1993 was noted on the cross-index plat and is assigned page No. 5341, in book No. _____

Coral M. Cummings By OS
County Official

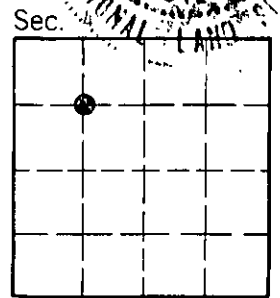

B-10 T. 30 N. R. 30 W. PMM

• - corner this sheet