

INSTRUCTIONS

1. Original and/or subsequent record used to evaluate the corner position.
2. Description of evidence found, note discrepancies in the record, state method of establishing lost or obliterated corners.
3. Description of monument and accessories set to perpetuate the corner position.
4. Sketch of corner, show all pertinent data which can best be shown in a sketch example, corner marking, topography ties, position of accessories, etc.
5. Certification must be signed and sealed by Land Surveyor registered in the State of Montana.
6. Fill in Cross Index & Section Diagram at bottom of sheet.

CERTIFIED CORNER RECORDATION

Corner of Secs. 21, 22, 27, 28 T. 30 N., R. 30 W., P.M.M. Lincoln County

- I. 1904 G.L.O. original record by G. W. Fessenden and R. Y. Lyman: Set a stone for the monument and marked four bearing trees.

1965 B.L.M. remonumentation record by D. G. Lindenberg: "The cor. of secs. 21, 22, 27, and 28, monumented with a slate stone, 24x18x10 ins., firmly set, marked with 2 notches on the S and 3 notches on the E edges and witnessed by the remains of the original bearing trees. At the corner point Set an iron post, 30 ins. long, 2 1/2 ins. diam., 26 ins. in the ground, with brass cap mkd.

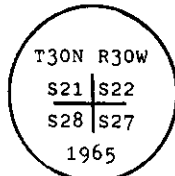

from which

The original bearing trees:

- A snag, 18 ins. diam., bears N32 1/2° E, 41 lks. dist., mkd. T30N R30W S22 BT. (Record)
- A snag, 14 ins. diam., bears S59° E, 24 lks. dist., mkd. T30N R30W S27 BT. (Record S54° E, 24 lks.)
- A larch, 25 ins. diam., bears S71 1/2° W, 40 lks. dist., mkd. 30 R30. (Record)
- A rotted stump, bears N37° W, 42 lks. dist. with fallen log mkd. T30N R30W S21 BT. (Record)

The new bearing trees:

- A fir, 8 ins. diam., bears N81° E, 18 lks. dist., mkd. T30N R30W S22 BT.
- A fir, 13 ins. diam., bears S56 1/2° E, 59 lks. dist., mkd. T30N R30W S27 BT.
- A fir, 8 ins. diam., bears N81° W, 57 lks. dist., mkd. T30N R30W S21 BT.

Bury the original stone alongside the iron post."

- II. Found a 2 1/2 ins. diam. iron pipe, 4 ins. out of ground, with a 3 1/4 ins. diam. brass cap, marked as shown above, from which

- A snag, 19 ins. diam., bears N31° E, 27.7 ft. (42.0 lks.) dist., mkd. 30N R30 S22.
- A douglas fir, 12 ins. diam., bears N82° E, 12.0 ft. (18.2 lks.) dist., scribe partially visible.
- A larch snag, 14 ins. diam., bears S63° E, 14.1 ft. (21.4 lks.) dist., mkd. T30N R30W S21 BT. (Record S59° E, 24 lks.)
- A douglas fir, 17 ins. diam., bears S55° E, 39.3 ft. (59.5 lks.) dist., scribe blaze pitched over.
- A larch snag, 25 ins. diam., bears S70° W, 26.2 ft. (39.7 lks.) dist., mkd. T30N R30W BT.
- A douglas fir, 7 ins. diam., bears N74° W, 32.7 ft. (49.5 lks.) dist., mkd. R30W S. (Record N81° W, 57 lks.)
- A root crown, bears N37° W, 31.3 ft. (47.4 lks.) dist., log portion mkd. T30N R30W S21 BT.

- III. Established one new bearing tree:

A douglas fir, 9 ins. diam., bears S33° W, 23.0 ft. dist., mkd. T30N R30W S28 BT.

Set a 6 ft. galvanized steel guard post with Land Survey Marker and Property Boundary decals, East, 2.5 ft. Painted red bands around the bearing trees and attached Bearing Tree and Land Survey Monument signs Magnetic Declination: 21° 30' East

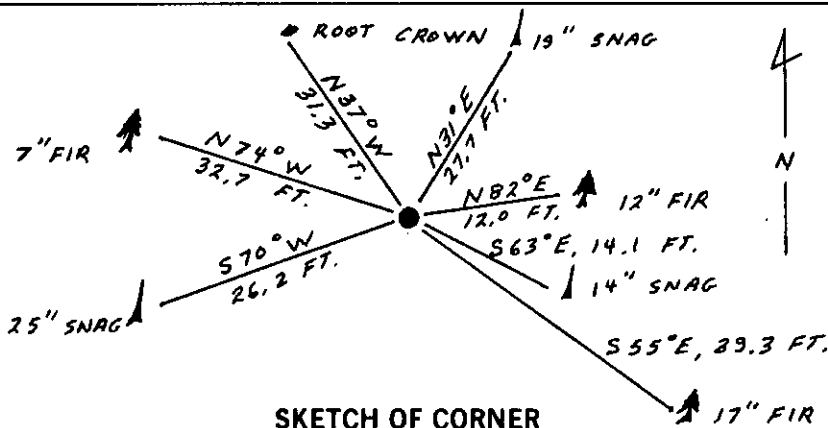

SKETCH OF CORNER

CERTIFICATION
Gary C. Crismon
I, Gary C. Crismon, certify the information shown herein is true and correct.

Signature Ground Party
Ronald A. Pearson
I, Ronald A. Pearson, certify that this Corner Record correctly represents work performed by me or under my direction in compliance with the "Corner Recordation Act" (70-22-101, et seq., M.C.A.)

Signature of Surveyor & Seal
Date: 6/20/90 Reg. No. 9008LS
U.S. FOREST SERVICE
Employer:

Office of Clerk and Recorder, County of Lincoln. This "corner record" was filed for record on Aug 6, 1990 was noted on the cross-index plat and is assigned page No. 4275, in book No. 157 signed by Bill Bushong

County Official

R-13 30 N 30 W
Cross Index No. T. R. PMM

Sec. 21

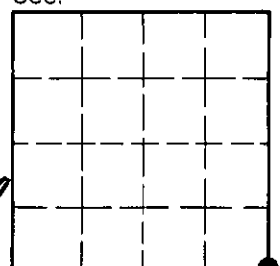

• - corner this sheet