

## INSTRUCTIONS

1. Original and/or subsequent record used to evaluate the corner position.
2. Description of evidence found, note discrepancies in the record, state method of establishing lost or obliterated corners.
3. Description of monument and accessories set to perpetuate the corner position.
4. Sketch of corner, show all pertinent data which can best be shown in a sketch example, corner marking, topography ties, position of accessories, etc.
5. Certification must be signed and sealed by Land Surveyor registered in the State of Montana.
6. Fill in Cross Index & Section Diagram at bottom of sheet.

## CERTIFIED CORNER RECORDATION

of Secs. 7 & 18  
Corner of Secs. 12 & 13 T. 30 N., R. 30 W., P.M.M. Lincoln County

- I. 1898 G.L.O. original record by Paul S.A. Bickel: Set a stone monument and three bearing trees.

1965 B.L.M. remonumentation record by Duane C. Lindenberg: "The cor. of secs. 7, 12, 13, and 18, on the W. bdy. of the tp., monumented with a slate stone, 16 x 8 x 6 ins., firmly set, marked with 4 notches on the S. and 2 notches on the N. edges and witnessed by the original bearing trees. At the corner point, set an iron post, 30 ins. long, 2 1/2 ins. diam., 26 ins. in the ground, with brass cap mkd.

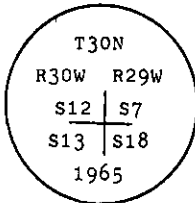

from which

The original bearing trees:

- A pine, 27 ins. diam., bears N8°10'E, 320 lks. dist., mkd. T30N R29W S7 BT. (Record)  
A pine, 30 ins. diam., bears S49°20'E, 93 lks. dist., mkd. T30N R29W S18 BT. (Record)  
A pine, 26 ins. diam., bears N44°W, 262 lks. dist., mkd. T30N R30W S12 BT. (Record)

The new bearing trees:

- A pine, 12 ins. diam., bears N72 1/2°W, 104 lks. dist., mkd. X BT.

Bury the original stone alongside the iron post."

- II. Found, a 2 1/2 in. dia. iron pipe, 2 ins. out of ground with a 3 1/4 in. dia., B.L.M. brass cap marked as shown above, from which

A ponderosa pine, 26 ins. diam., bears N11°E, 211.9 ft. (321.0 lks.) dist., scribe R29 is visible. (G.L.O.)

A stump hole with log, 29 ins. diam., bears S46°E, 61.4 ft. (93.0 lks.) dist., scribe is visible. (G.L.O.)

A ponderosa pine, 21 ins. diam., bears N71°W, 68.9 ft. (104.4 lks.) dist., scribe overgrown. (B.L.M.)

A ponderosa pine snag, 26 ins. diam., bears N40°W, 172.2 ft. (260.9 lks.) dist., all scribe visible. (B.L.M.)

- III. Unable to mark new bearing trees, as no trees available within limits.

Painted red bands around the bearing trees and attached Land Survey Monument and Bearing Tree signs.

Set a 6 ft. galvanized steel guard post with Land Survey Marker and Property Boundary decals, south, 3 ft. Magnetic declination: 20°30' East

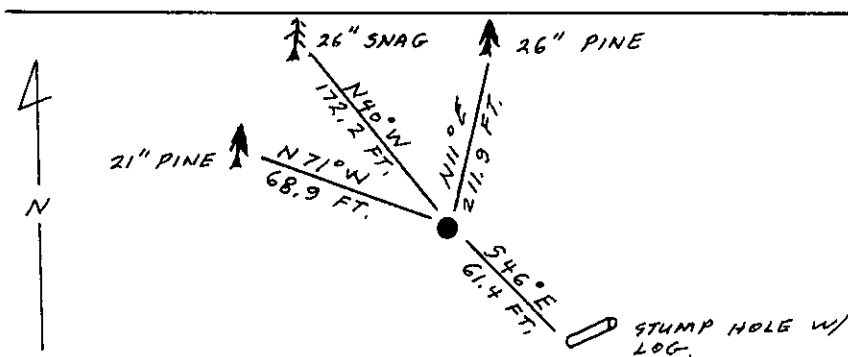

SKETCH OF CORNER

## CERTIFICATION

I, Gary C. Crismon  
certify the information shown herein is true and correct.

*Gary C. Crismon*  
Signature Ground Party Chief

I, Alvah F. Hughes  
certify that this Corner Record correctly represents work performed by me or under my direction in compliance with the Corner Recordation Act" (70-22-101, et seq., M.C.A.)

*Alvah F. Hughes*  
Signature of Surveyor & Seal

Date: 12/26/89 Reg. No. 7322

Employer: U.S. FOREST SERVICE

Office of Clerk and Recorder, County of Lincoln. This "corner

record" was filed for record on Dec 29, 1989

was noted on the cross-index plat and is assigned page No. 4185, in

book No. \_\_\_\_\_

Cross Index No. J-25 T. 30 N R. 30 W PMM

