

## INSTRUCTIONS

1. Original and/or subsequent record used to evaluate the corner position.
2. Description of evidence found, note discrepancies in the record, state method of establishing lost or obliterated corners.
3. Description of monument and accessories set to perpetuate the corner position.
4. Sketch of corner, show all pertinent data which can best be shown in a sketch example, corner marking, topography ties, position of accessories, etc.
5. Certification must be signed and sealed by Land Surveyor registered in the State of Montana.
6. Fill in Cross Index & Section Diagram at bottom of sheet.

## CERTIFIED CORNER RECORDATION

Corner SW Cor. Sec. 3 T. 30N. R. 30W. P.M.M. Lincoln County  
I. 1898 ORIGINAL, GLO record by Paul Bickel: "Set a limestone, 20 x 14 x 9 ins. 15 ins. in the ground, for Cor. of Secs. 3, 4, 9 & 10 marked with 5 notches on S and 3 notches on E edges" from which

- A pine, 10 ins. diam. bears N48°30'E, 66 lks. dist. marked T30N R30W S3 BT  
A tamarack, 30 ins. diam. bears S48°10'E, 77 lks. dist. marked T30N R30W S10 BT  
A pine, 26 ins. diam. bears S28°10'W, 69 lks. dist. marked T30N R30W S9 BT  
A tamarack, 42 ins. diam. bears N74°30'W, 13 lks. dist., marked T30N R30W S4 BT

1962 BLM Remonumentation, by Pittman, Larimer and Grusing: "The cor. of secs. 3, 4, 9 and 10, monumented with a limestone, 20 x 14 x 9 ins., loosely set and mkd. as described in the official record, and witnessed by remains of the original bearing trees. At the corner point

Set an iron post, 30 ins. long, 2 1/2 ins. diam., 26 ins. in the ground, with brass cap mkd.

T30N R30W  
S4 | S3  
S9 | S10  
1962

From which the remains of the original bearing trees:

- A stump, bears N48 1/2° E, 66 lks. dist. (Record)  
A stump, 30 ins. diam., bears S48°10'E, 77 lks. dist., no marks visible (Record)  
A stump, 26 ins. diam., bears S28°10'W, 69 lks. dist., visible marks BT (Record)  
A dead larch, 42 ins. diam., bears N74 1/2° W, 13 lks. dist., mkd. T30N R30W S4 BT (Record)

The new bearing trees:

- A pine, 18 ins. diam., bears N18° E, 51 lks. dist., mkd. T30N R30W S3 BT.  
A fir, 7 ins. diam., bears S84° E, 55 lks. dist., mkd. T30N R30W S10 BT.  
A fir, 10 ins. diam., bears S31 1/2° W, 64 lks. dist., mkd. T30N R30W S9 BT.  
A fir, 6 ins. diam., bears N69 1/2° W, 71 lks. dist., mkd. T30N R30W S4 BT."

Bury the original stone alongside and raise a flat mound of stone, 4 ft. diam., around the iron post.

1974 Cadastral retracement, Certified Corner Recordation No. 4043, by John Erickson, Reg. No. 3979S: Found BLM brass cap marked as shown above, one GLO bearing tree and four BLM bearing trees.

Certified Corner Recordation No. 382, 1975, by J. Ninneman, Reg. No. 534ES: B.C. by BLM.

II. I found a BLM brass cap marked as shown above with a 3 ft. diam. mound of stone, from which

The original bearing trees:

- A stump, 28 ins. diam., bears S46° E, 50.0 ft. (76 lks.) dist., with scribe visible.  
A stump, 20 ins. diam., bears S32° W, 46.5 ft. (70 lks.) dist., with scribe visible.  
A root crown with log, 40 ins. diam., bears N66° W (Record: N74 1/2° W), 10.2 ft. (15 lks.) dist., with no scribing visible.

The BLM bearing trees:

- A pine, 24 ins. diam., bears N19° E, 34.3 ft. (52 lks.) dist., scribe overgrown.  
A douglas fir, 12 ins. diam., bears S82° E, 36.3 ft. (55 lks.) dist., scribe overgrown.  
A douglas fir, 17 ins. diam., bears S34° W, 42.4 ft. (64 lks.) dist., scribe pitched over.  
A douglas fir, 18 ins. diam., bears N70° W, 47.1 ft. (71 lks.) dist., scribe overgrown.

III. Set a 6 ft. galvanized steel guard post with Land Survey Marker decal, 3 ft. west of the monument. Painted a red band around each bearing tree and attached Survey Monument and Bearing Tree signs.  
Use 19° E. declination.

## CERTIFICATION

I, Gary Crismon  
certify the information shown herein is true and correct.

*Gary Crismon*  
Signature Ground Party Chief

I, Alvah F. Hughes  
certify that this Corner Record correctly represents work performed by me or under my direction in compliance with the "Corner Recordation Act" (70-22-101, et seq., M.C.A.)

*Alvah F. Hughes*  
Signature of Surveyor

Date: 12/7/89 Reg. No. 73226  
U.S. FOREST SERVICE

Employer: *U.S. FOREST SERVICE*

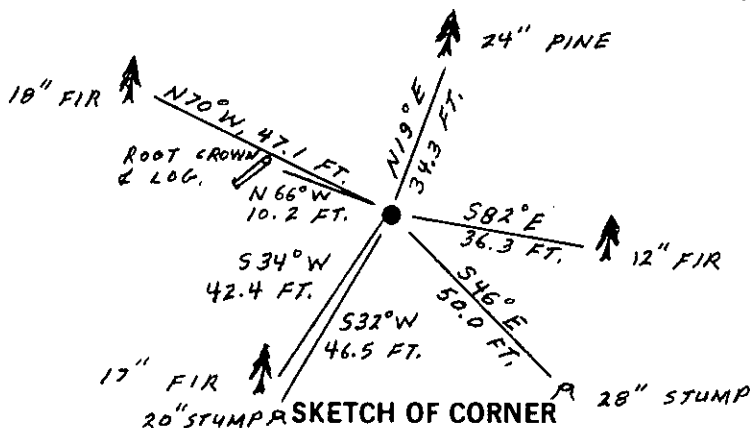

Office of Clerk and Recorder, County of Lincoln. This "corner record" was filed for record on Dec 19, 1989

was noted on the cross-index plat and is assigned page No. 4169 in book No.         

Cross Index No. E-13 T. T30N R. R30W P.M.M.

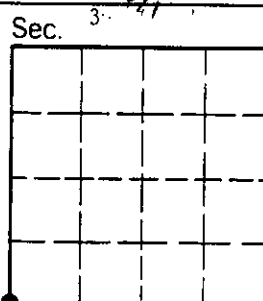

• - corner this sheet