

CERTIFIED LAND CORNER RECORDATION

DESCRIPTION OF CORNER EVIDENCE FOUND, AND ORIGINAL RECORD (IF KNOWN)

T30N R30W Montana Principal Meridian G.L.O. notes book 8958 page 179
has 30" iron post 2 1/2" in diameter, 26" in the ground with a brass cap
marked T30N R30W Found brass cap in good condition and undisturbed

S15 | S14
S22 | S23
1965

Record: 15" larch bearing N77°E, 20 lks., marked T30N R30W
Found: Bearing tree alive and presently 16" in diameter

Record: 11" snag bearing S65°20'E, 77 lks., marked T30N R30W S23 BT
Found: 11" snag still standing bearing S69°E

CONTINUED ON REVERSE SIDE

DESCRIPTION OF MONUMENT AND ACCESSORIES ESTABLISHED
TO PERPETUATE THE ORIGINAL LOCATION OF THIS CORNER:

Date of work June '74

No added monumentation

SKETCH, WITH COURSE AND DISTANCE TO ADJACENT CORNERS IF DETERMINED IN THIS SURVEY.
(MAY SKETCH OR PASTE REPRODUCTION ON REVERSE SIDE.)

See reverse side

Surveyor's Seal

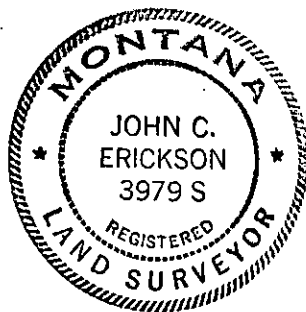

I, James R. Staples
certify that the information shown herein is true and correct.

James R. Staples
Signature of Ground Party Chief

I, JOHN C. ERICKSON
certify that I have carefully performed or reviewed the work done on the diagrammed corner as reported on this recordation form and approve the same.

John C. Erickson
Signature of Surveyor

3979 S
Registration Number

DIAGRAM OF CORNER:

N. T30N R30W

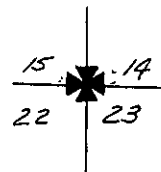

= Corner recorded on the sheet

Office of Clerk and Recorder, County of Lincoln

This "corner record" was filed for record on the 28 day of Mar 1989, was noted on the cross-index plat and is assigned page No. 4030, in book No. [blank]

Grant H. Sigelby
County Official

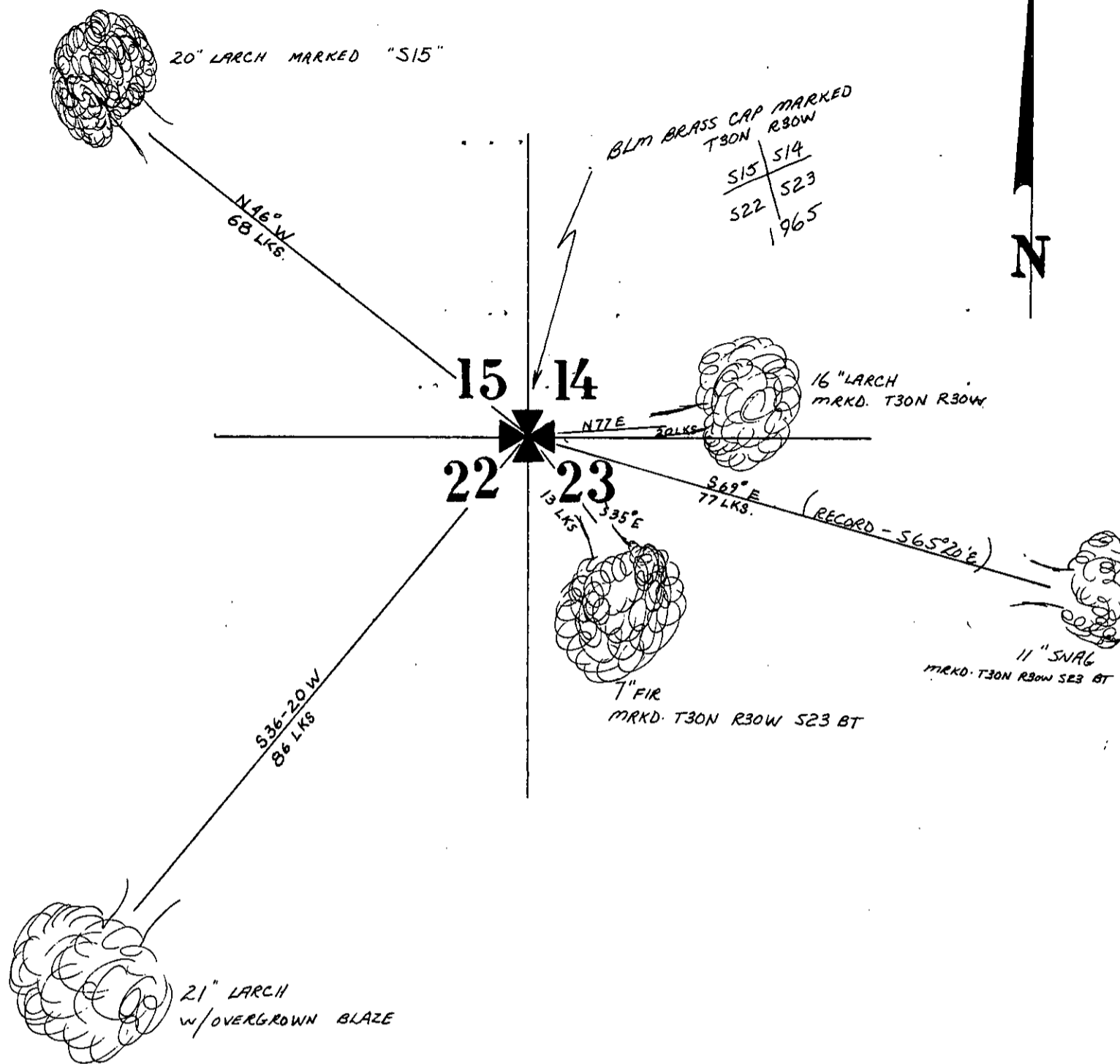

Description of evidence and original record continued from page 1

Record: 5" fir bearing S35°E, 13 lks., marked T30N R30W S23 BT
 Found: Bearing tree alive and presently 7" in diameter

Record: 17" larch bearing S36°20'W, 86 lks., marked with an overgrown blaze
 Found: Bearing tree alive and presently 21" in diameter

Record: 17" larch bearing N46°W, 68 lks., marked S15
 Found: Bearing tree alive and presently 20" in diameter