

CERTIFIED CORNER RECORDATION

Corner C-W 1/16 S18 T. 30 N. R. 30 W. P.M.M. Lincoln County

I. Record: 1980 Certificate Survey No. 751 Lincoln County Records, by Thomas C. Hill 5612S.

II. Found: A field search found no monuments.

III. Perpetuation: At the corner point, determined by survey, set a 5/8 ins. diam. steel rebar 24 ins. long, 22 ins. in the ground, with a 3 1/4 ins. diam. Aluminum cap marked as shown below from which:

A Douglas fir, 28 ins. diam., bears N52°E, 25.30 ft. dist., scribed C-W 1/16 S18 BT.

A Douglas fir, 34 ins. diam., bears S85°W, 34.60 ft. dist., scribed C-W 1/16 S18 BT.

Painted faces and 6 in. wide red bands to all bearing trees and attached Land Survey Monument and Bearing Tree signs.

Magnetic declination: 18° East

Equipment used: Hand compass and loggers tape

NOTE: Refer to Certificate of Survey No. 3985FC Lincoln County Records for additional survey information.

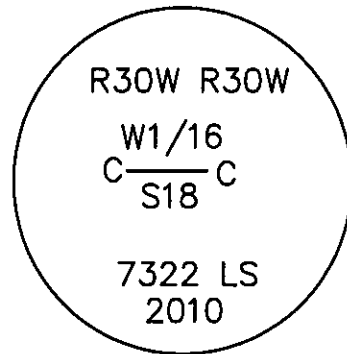

Kootenai Surveyors Inc., 314 California Av., Libby, MT. 59923 (406) 293-4354

TUNGSTEN Sec. 18

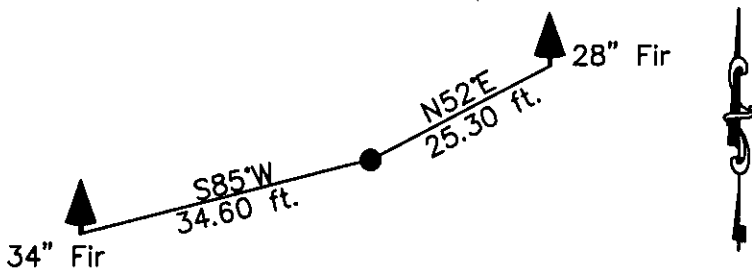

SKETCH OF CORNER

CERTIFICATION  
I, Kelly Rooney  
certify the information shown herein is true and correct.  
Signature Ground Party Chief  
Alvah F. Hughes  
certify that this Corner Record correctly represents work performed by me or under my direction in compliance with the "Corner Recordation Act" (70-22-101, et seq., M.C.A.)  
Signature of Surveyor & Seal  
Date: 04/1/2010 Reg. No. 7322LS  
Employer: Kootenai Surveyors Inc.

Office of Clerk and Recorder, County of Lincoln This "corner

record" was filed for record on 225445 BOOK: CCR CC&R'S PAGE: 11508 Pages: 1  
was noted on the cross-Ind STATE OF MONTANA LINCOLN COUNTY  
book No. RECORDED: 04/06/2010 11:10 KOI: CC&R'S  
TAMMY D. LAUER CLERK AND RECORDER  
FEE: \$0.00 BY: *[Signature]*  
TO: KOOTENAI SURVEYORS INC. P.O. BOX 393, LIBBY, MT 59923

Cross Index No. L 02 T. 30N R. 30W P.M., MT

Adopted July 1, 1981, Montana Board of Professional Engineers & Land Surveyors

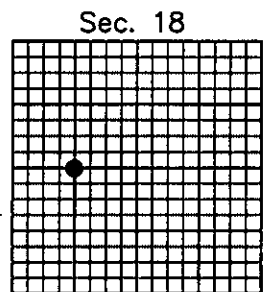

• corner this sheet