

CERTIFIED CORNER RECORDATION

Corner S 1/16 S18 T. 30 N. R. 30 W. P.M.M. Lincoln County

I. Record: 1980 Certificate Survey No. 751 Lincoln County Records, by Thomas C. Hill 5612S.

II. Found: A field search found no monuments.

III. Perpetuation: At the corner point, determined by survey, set a 5/8 ins. diam. steel rebar 24 ins. long, 22 ins. in the ground, with a 3 1/4 ins. diam. Aluminum cap marked as shown below from which:

A Douglas fir, 12 ins. diam., bears N5°E, 41.00 ft. dist., scribed S 1/16 S18 BT.

A Douglas fir, 10 ins. diam., bears N77°E, 26.70 ft. dist., scribed S 1/16 S18 BT.

Painted faces and 6 in. wide red bands to all bearing trees and attached Land Survey Monument and Bearing Tree signs.

A Set Carsonite property line post bears North 2.50 ft. dist.

Magnetic declination: 18° East

Equipment used: Hand compass and loggers tape

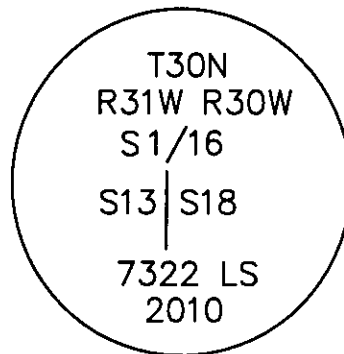

NOTE: Refer to Certificate of Survey No. 3985FC Lincoln County Records for additional survey information.

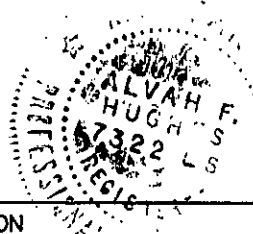

Kootenai Surveyors Inc., 314 California Av., Libby, MT. 59923 (406) 293-4354

TUNGSTEN Sec. 18

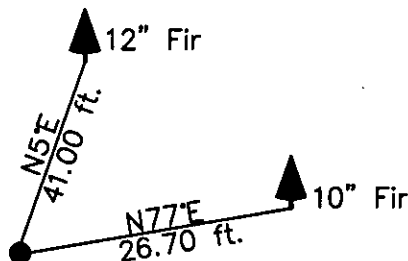

SKETCH OF CORNER

CERTIFICATION

I, Kelly Rooney
certify the information shown herein is true and correct.
Kelly Rooney
Signature Ground-Party Chief

I, Alvah F. Hughes
certify that this Corner Record correctly represents work performed by me or under my direction in compliance with the "Corner Recordation Act" (70-22-101, et seq., M.C.A.)
Alvah F. Hughes
Signature of Surveyor & Seal

Date: 04/1/2010 Reg. No. 7322LS

Employer: Kootenai Surveyors Inc.

Office of Clerk and Recorder, County of Lincoln This "corner

record" was filed for record on 225443 BOOK: CCR CC&R'S PAGE: 11506 Pages: 1

was noted on the cross-index STATE OF MONTANA LINCOLN COUNTY

book No. TAMMY D. LAUER CLERK AND RECORDER

FEE: \$0.00 BY: Scannie Davis
TO: KOOTENAI SURVEYORS INC. P.O. BOX 393, LIBBY, MT 59923

Cross Index No. M 01 T. 30N R. 30W P.M., MT

Adopted July 1, 1981, Montana Board of Professional Engineers & Land Surveyors

Sec. 18

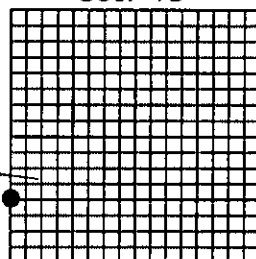

• corner this sheet