

CERTIFIED CORNER RECORDATION

Corner SW 1/16 S18 T. 30 N. R. 30 W. P.M.M. Lincoln County

I. Record: 1980 Certificate Survey No. 751 Lincoln County Records, by Thomas C. Hill 5612S.

II. Found: A field search found no monuments.

III. Perpetuation: At the corner point, determined by survey, set a 5/8 ins. diam. steel rebar 24 ins. long, 22 ins. in the ground, with a 3 1/4 ins. diam. Aluminum cap marked as shown below from which:

A larch, 12 ins. diam., bears N25°E, 22.30 ft. dist., scribed SW 1/16 S18 BT.

A Douglas fir, 12 ins. diam., bears S66°W, 14.20 ft. dist., scribed SW 1/16 S18 BT.

Painted faces and 6 in. wide red bands to all bearing trees and attached Land Survey Monument and Bearing Tree signs.

Set a steel fence post along side set monument.

Magnetic declination: 18° East

Equipment used: Hand compass and loggers tape

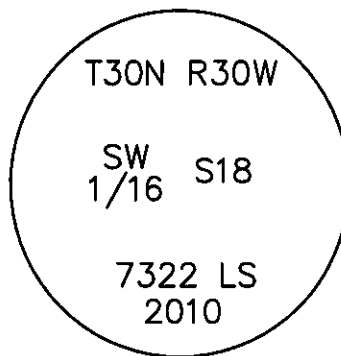

NOTE: Refer to Certificate of Survey No. 3985FC Lincoln County Records for additional survey information.

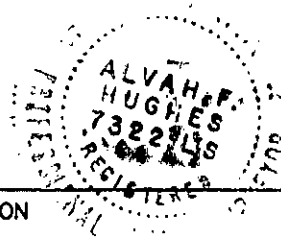

Kootenai Surveyors Inc., 314 California Av., Libby, MT. 59923 (406) 293-4354

TUNGSTEN Sec. 18

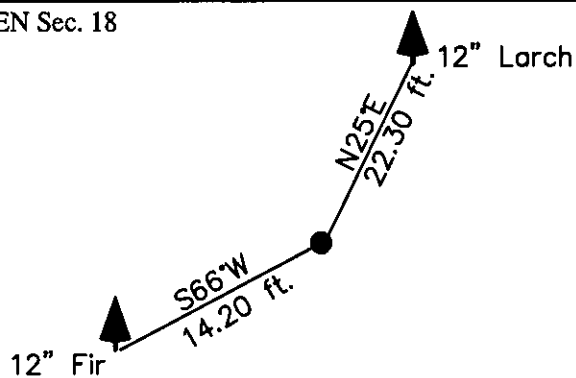

SKETCH OF CORNER

CERTIFICATION

I, Kelly Rooney
certify the information shown hereby is true and correct.
Kelly Rooney
Signature Ground Party Chief

I, Alvah F. Hughes
certify that this Corner Record correctly represents work performed by me or under my direction in compliance with the "Corner Recordation Act" (70-22-101, et seq., M.C.A.)
Alvah F. Hughes
Signature of Surveyor & Seal

Date: 04/1/2010 Reg. No. 7322LS

Employer: Kootenai Surveyors Inc.

Office of Clerk and Recorder, County of Lincoln This "corner

record" was filed for record on 225441 BOOK: CCR CC&R'S PAGE: 11504 Pages: 1
was noted on the cross-index STATE OF MONTANA LINCOLN COUNTY
book No. _____ RECORDED: 04/06/2010 11:00 KOI: CC&R'S
TAMMY D. LAUER CLERK AND RECORDER

FEE: \$0.00 BY *Gloria Durrant*
TO: KOOTENAI SURVEYORS INC. P.O. BOX 393, LIBBY, MT 59923

Cross Index No. M 02 T. 30N R. 30W P.M., MT

Adopted July 1, 1981, Montana Board of Professional Engineers & Land Surveyors

Sec. 18

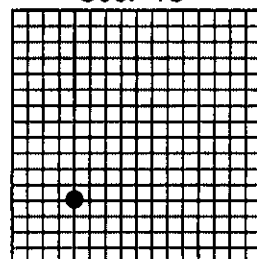

• corner this sheet