

CERTIFIED CORNER RECORDATION

Corner C 1/4 T. 30 N. R. 30 W. P.M.M. Lincoln County

I. Record: None

II. Found: No monument or accessories found during area search.

III. Perpetuation: At the corner point, determined by survey, set a 5/8 ins. diam. steel rebar 24 ins. long 22 ins. in the ground, with a 3 1/4 ins. diam. Aluminum cap marked as shown below from which:

A larch, 16 ins. diam., bears S.61°E., 6.50 ft. dist., scribed C 1/4 S34 BT.
A fir, 7 ins. diam., bears S.16° W., 16.55 ft. dist., scribed X BT.

Painted faces and 6 in. wide red bands to all bearing trees and attached Land Survey Monument and Bearing Tree signs.

Set a steel post on line 3.00 North, with Land Survey and Property Line stickers attached.

Magnetic declination: 18° East

Equipment used: Hand compass and loggers tape

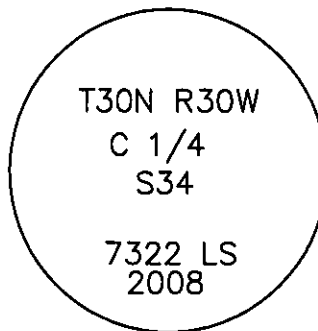

Kootenai Surveyors Inc., 314 California Av., Libby, MT. 59923 (406) 293-4354

Swede 34- PCTC

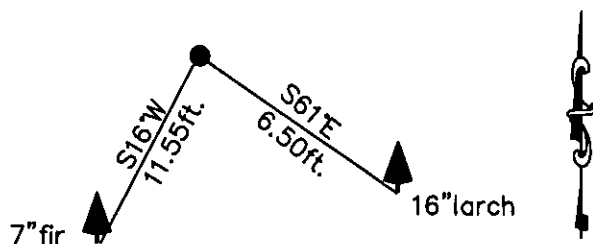

SKETCH OF CORNER

CERTIFICATION

I, Mike Tester
certify the information shown herein is true and correct.

Alvah F. Hughes
Signature Ground Party Chief

I, Alvah F. Hughes
certify that this Corner Record correctly represents the survey performed by me or under my direction in compliance with the "Corner Recordation Act" (70-22-101, et seq., MCA).

Alvah F. Hughes
Signature of Surveyor & Seal

Date: 7/14/2008 Reg. No. 7322-LS

Employer: Kootenai Surveyors Inc.

Office of Clerk and Recorder, County of Lincoln This "corner

record" was 213041 BOOK: CCR CC&R'S PAGE: 11249 Pages: 1

was noted STATE OF MONTANA LINCOLN COUNTY

RECORDED: 07/23/2008 9:44 KOI: CC&R'S

book No. TAMMY D. LAUER CLERK AND RECORDER

FEE: \$0.00

BY: Alvah F. Hughes

TO: KOOTENAI SURVEYORS INC. P.O. BOX 393, LIBBY, MT 59923

Cross Index No. X 15 T. 30N R. 30W P.M., MT

Adopted July 1, 1981, Montana Board of Professional Engineers & Land Surveyors

Sec. 34

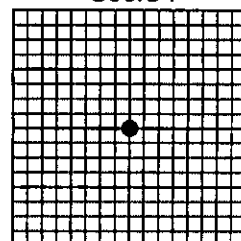

• corner this sheet