

# CERTIFIED CORNER RECORDATION

Corner E 1/4 S34 T. 30 N. R. 30 W. P.M.M. Lincoln County

I. Record: 1904 original GLO survey by G. Fessenden and R. Lyman: Set a slate stone 14x10x6 ins 9 ins. in the ground, marked 1/4 on the W. face from which:

A fir, 12 ins. diam., bears S.73°30'W., 95 lks. dist., (62.70 ft.), mkd. 1/4 S34 BT.  
A tamarack, 7 ins. diam., bears S52°15'E., 90 lks. dist., (59.40 ft.), mkd. 1/4 S35 BT.

1965 BLM Remonumentation by D. Lindenburg: Set a iron post, 30 ins. long, 2 1/2 ins. diam., 26 ins. in the ground with brass cap from which:

A larch, 14 ins. diam., bears S.52°15'E., 90 lks. dist., (59.40 ft.) visible scribes.  
A fir, 16 ins. diam., bears S73°30'W., 95 lks. dist., (62.70 ft.) mkd. S34.  
A fir, 6 ins. diam., bears N.26°E., 25 lks. dist., (16.50 ft.) mkd. 1/4 S35 BT.

II. Found: A 2 1/2 ins. diam. iron pipe with a 3 1/4 ins. diam. BLM brass cap 5 ins. above ground and firmly set from which :

A larch snag, 18 ins. diam., bears S.52°15'E., 59.40 ft. dist., with visible scribes.  
A fir, 18 ins. diam., bears S.73°30'W., 62.70 ft. dist., with visible scribes  
A fir, 10 ins. diam., bears N.26°E., 16.50 ft. dist., with overgrown face.

III. Perpetuation:

Painted faces and 6 in. wide red bands to all bearing trees and attached Land Survey Monument and Bearing Tree signs.

Magnetic declination: 18° East

Equipment used: Hand compass and loggers tape

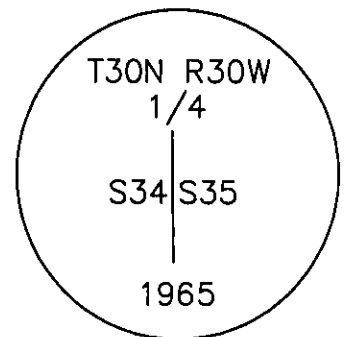

Kootenai Surveyors Inc., 314 California Av., Libby, MT. 59923 (406) 293-4354

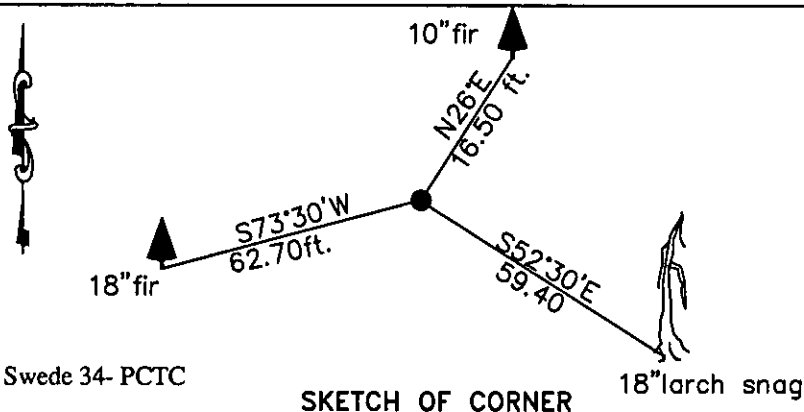

CERTIFICATION

1. Mike Tester  
certify the information shown herein is true and correct.  
*[Signature]*  
Signature Ground Party Chief

2. Alvah F. Hughes  
certify that this Corner Record correctly represents work performed by me or under my direction in compliance with the "Corner Recordation Act" (70-22-101, et seq.)  
*[Signature]*  
Signature of Surveyor & Seal

Date: 7/4/2008 Reg. No. 7322-LS  
Employer: Kootenai Surveyors Inc.

Office of Clerk and Recorder, County of Lincoln This "corner

record" was filed for record on 213037 BOOK: CCR CC&R'S PAGE: 11245 Pages: 1

was noted on the (STATE OF MONTANA LINCOLN COUNTY  
book No. RECORDED: 07/23/2008 9:43 KOI: CC&R'S

TAMMY D. LAUER CLERK AND RECORDER

FEE: \$0.00

TO: KOOTENAI SURVEYORS INC. P.O. BOX 393, LIBBY, MT 59923

Cross Index No. X 17 T. 30N R. 30W P.M., MT

Adopted July 1, 1981, Montana Board of Professional Engineers & Land Surveyors

