

CERTIFIED CORNER RECORDATION

Corner N 1/4 S34 T 30 N. R. 30 W. P.M.M. Lincoln County

I. Record: 1904 original GLO survey by G. Fessenden and R. Lyman: Set a slate stone 20x10x8 ins. 15 ins. in the ground, marked 1/4 on the N. face from which:

A fir, 9 ins. diam., bears N.64°45'E., 27 lks. dist., (17.82 ft.), mkd. 1/4 S 27 BT.
A fir, 6 ins. diam., bears South., 125 lks. dist., (82.50 ft.), mkd. 1/4 S 34 BT.

1965 BLM Remonumentation by D. Lindenburg: Set a iron post, 30 ins. long, 2 1/2 ins. diam., 26 ins. in the ground with brass cap from which:

A fir, 14 ins. diam., bears N.64°45'E., 27 lks. dist., (17.82 ft.) mkd. S 27.
A fir, 20 ins. diam., bears South., 125 lks. dist., (82.50 ft.) with overgrown blaze.

II. Found: A 2 1/2 ins. diam. iron pipe with a 3 1/4 ins. diam. BLM brass cap 5 ins. above ground and firmly set from which :

A fir, 24 ins. diam., bears S.8°W., 82.50 ft. dist., with overgrown face.
A fir snag, 16 ins. diam., bears N.64°E., 19.80 ft. dist., with overgrown face.
A carsonite post with Property line and Survey Monument stickers bears 8 ft. East from found monument.

III. Perpetuation: Establish one new bearing tree described below:

A fir, 7 ins. diam., bears N.26°E., 10.90 ft. dist., scribed 1/4 S27 BT.

Painted faces and 6 in. wide red bands to all bearing trees and attached Land Survey Monument and Bearing Tree signs.

Magnetic declination: 18° East

Equipment used: Hand compass and loggers tape

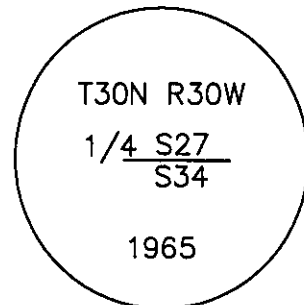

Kootenai Surveyors Inc., 314 California Av., Libby, MT. 59923 (406) 293-4354

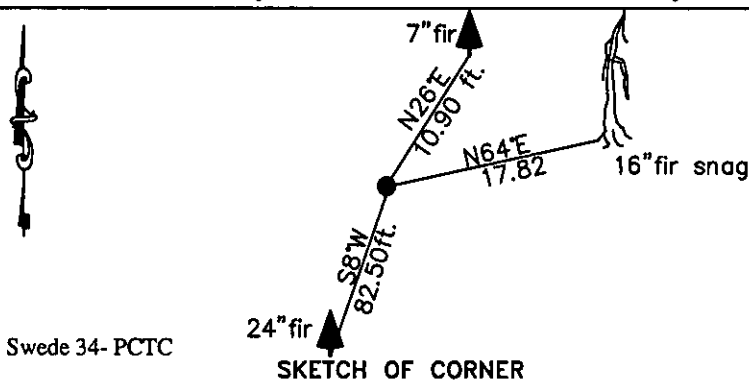

CERTIFICATION
I, Mike Tester
certify the information shown herein is true and correct.
[Signature]
Signature Ground Party Chief
I, Alvah F. Hughes
certify that this Corner Record correctly represents work performed by me or under my direction in compliance with the "Corner Recordation Act" (70-22-101, et seq. M.C.A.)
[Signature]
Signature of Surveyor & Seal
Date: 7/4/2008 Reg. No. 7322-LS
Employer: Kootenai Surveyors Inc.

Office of Clerk and Recorder, County of Lincoln This "corner

record" was filed for 213036 BOOK: CCR CC&R'S PAGE: 11244 Pages: 1

STATE OF MONTANA LINCOLN COUNTY

was noted on the c RECORDED: 07/23/2008 9:42 KOI: CC&R'S

book No. TAMMY D. LAUER CLERK AND RECORDER

FEE: \$0.00

BY: [Signature]

TO: KOOTENAI SURVEYORS INC. P.O. BOX 393, LIBBY, MT 59923

Cross Index No. V 15 T. 30N R. 30W P.M., MT

Adopted July 1, 1981, Montana Board of Professional Engineers & Land Surveyors

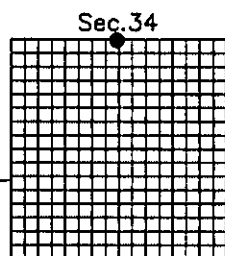

• corner this sheet