

# CERTIFIED CORNER RECORD

Corner: S 1/16 S 36

Twp. 30 N., R. 30 W., P.M.M.

Lincoln County

Record :

NONE

Found Evidence :

NONE

Perpetuation :

Established two new bearing trees and set a 5/8 inch diameter rebar 24 inches long 20 inches in the ground with a 1 1/4 inch diameter YPC stamped: 4975-S.

From which:

A 18 inch DBH Douglas fir scribed S 1/16 S 36 BT Bears S 45° W 41.4 feet distance.

A 6 inch DBH Douglas fir scribed X BT Bears N 33° W 41.2 feet distance.

Painted 6 inch wide bands and attached warning tags and bearing tree signs to both trees.

Declination 18 °E

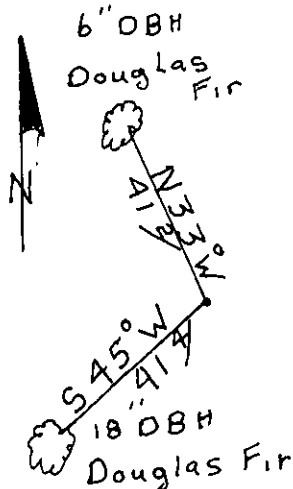

Sketch of Corner

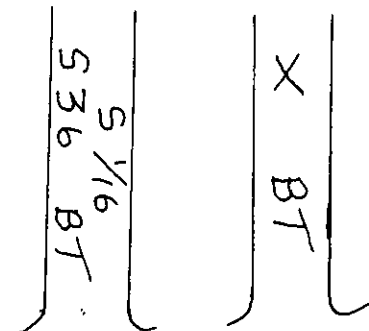

## CERTIFICATION

I, Randy Borgman

certify the information shown herein is true and correct

Signature of Ground Party Chief

Signature of Surveyor: JENNETH F. DAVIS  
I certify that this Corner Record correctly represents work performed under my direction in compliance with the "Corner Records Act"

JENNETH F. DAVIS  
(10-22-101, et seq., M.O.A.)

Signature of Surveyor: JENNETH F. DAVIS

Date: 12/12/08

Employer: Davis Surveying, Inc.

Section

Office of Clerk and Recorder, County of Lincoln

This "corner record" was filed for record on 12/12/08

was noted on the cross-index plat and is assigned page No. 10461

In book No. \_\_\_\_\_ Corral M. Cummings By DBB  
County Official

Cross Index No. S 1/16 S 36 Twp. 30 N., R. 30 W., P.M.M.

• THIS CORNER

