

CERTIFIED CORNER RECORDATION

Corner Sec. Cor. Sec. 16, 17, T. 30N R. 29W P.M., MT Lincoln County
20&21

I. 1898 G.L.O. original record by Paul S. A. Bickel: Set a stone and 4 bearing trees.

1965 B.L.M. remonumentation record by Duane C. Lindenberg: The cor. of secs. 16, 17, 20 & 21, monumented with a slate stone, 20x12x6 ins., firmly set, marked with 4 notches on the E. and 3 notches on the S. edges and witnessed by the remains of the original bearing trees:

A rotted stump, bears N88°E, 24 lks. dist., no visible marks. (record)

A rotted stump, bears S18 1/2°E, 31 lks. dist., with fallen log, mkd. "T30N R29W S21 BT". (record)

A fir, 13 ins. diam., bears S39°W, 28 lks. dist., with healed face. (rec.-S17°20'W)

A rotted stump, bears N50°40'W, 50 lks. dist., with fallen log mkd. "T30N R29W S17 BT". (record)

At the corner point, set a 2 1/2 in. diam., 30 in. long iron post, 26 ins. in the ground, with brass cap marked:

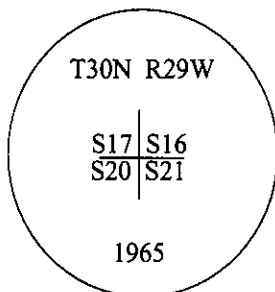

Established three new bearing trees.

II. Found a 2 1/2 in. iron pipe, protruding 12 ins. out of ground, firmly set, with a 2 in. diam. brass cap mkd. as shown above, from which:

A fir snag, 10 ins. diam., bears N77°E, 23.8 ft. dist., mkd. with a visible scribing. (B.L.M. rec.)

A fir snag, 11 ins. diam., bears S57°E, 14.5 ft. dist., mkd. with visible scribing. (B.L.M. rec.)

A fir snag, 14 ins. diam., bears S39°W, 17.5 ft. (26.5 lks.) dist., mkd. with visible scribing. (G.L.O. rec.-S17°20'W, 28 lks.)

A pine stump with tree alongside, bears N40°W, 7.3 ft. dist., mkd. with visible scribing. (B.L.M. record)

III. This corner lies in the 1978 Jennings' Fire burn, with only one suitable tree within limits for a new BT:

A larch, 4 ins. diam., bears N88°W, 5.9 ft. dist., mkd. "X" "BT".

Painted bearing trees and attached Land Survey Monument and Bearing Tree signs.

Magnetic Declination: 20° East.

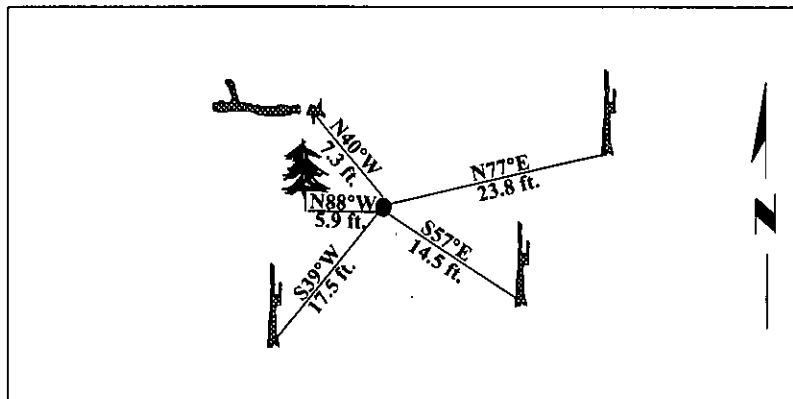

SKETCH OF CORNER

CERTIFICATION
I, Mark Federman
certify the information shown herein is true and correct.

Mark Federman

I, Alvah F. Hughes
certify that this Corner Record correctly represents work performed by me or under my direction in compliance with the "Corner Recordation Act" (70-22-101, et seq., M.C.A.)

Alvah F. Hughes
Signature of Surveyor & Seal

Date: 12/03/96

Reg. No.: 7322LS

Employer: U.S. FOREST SERVICE

Sec. 17

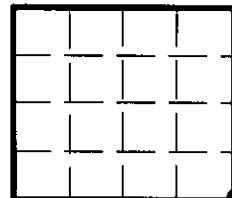

• - corner this sheet

Office of Clerk and Recorder, County of LINCOLN. This "corner record" was filed for record on FEB 3, 1997 and was noted on the cross-index plat and is assigned page No. 9125, in book No. CORAL M. CUMMINGS

County Official *by [Signature]*