

CERTIFIED CORNER RECORDATION

Corner **S 1/4** **Sec. 17** **T. 30N** **R. 29W** **P.M., MT** **Lincoln** **County**

- I. 1898 G.L.O. orig. record by Paul S. A. Bickel: Set a slate stone, 16 x 14 x 6 ins., 11 ins. in the ground, for 1/4 Sec. Cor. marked "1/4" on N. face, from which:
- A fir, 12 ins. diam., bears S13°20'E, 88 lks. dist., mkd. "1/4 S20 BT".
A fir, 18 ins. diam., bears N80°W, 33 lks. dist., mkd. "1/4 S17 BT".
- II. Found a slate stone, 14 x 6 ins., protruding 6 ins. out of the ground, firmly set and mkd. "1/4" on North face, from which:
- A fir snag, 18 ins. diam., bears S13°E, 58 ft. (88 lks.) dist., mkd. with a healed face.
A fir snag, 22 ins. diam., bears N80°W, 20.6 ft. (31.2 lks.) dist., mkd. with a healed face.
(Sawed into snag and found scribing.)
- III. At the position of the found corner stone, set a 2 1/2 in. diam., 30 in. long aluminum pipe, 20 ins. in the ground, with a 3 1/4 in. diam. alum. cap mkd. as shown.

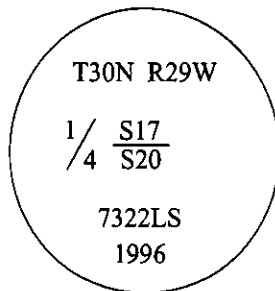

Established two new bearing trees:

- A larch, 3 ins. diam., bears S86°E, 44.9 ft. dist., mkd. "X" on a snowblaze, "BT".
A larch, 4 ins. diam., bears S16°E, 69.9 ft. dist., mkd. "1/4 S20 BT".
(No suitable trees, within limits, were available in sec. 17)

Painted bearing trees and attached Land Survey Monument and Bearing Tree signs.

Buried original stone alongside, and raised a collar of stone, 2 ft. diam., around alum. monument.

Magnetic Declination: 20° East.

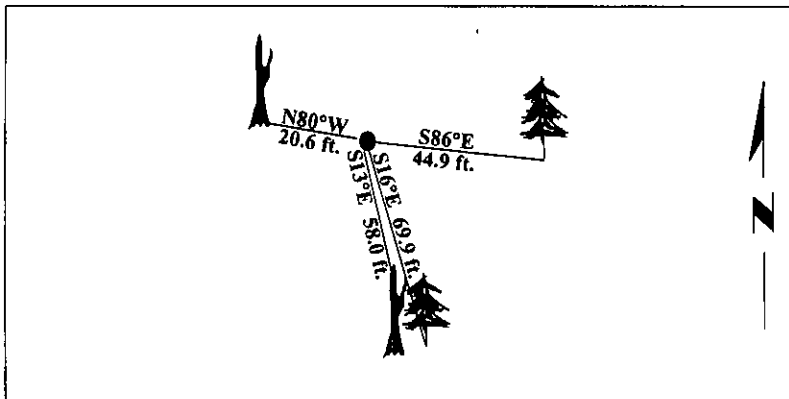

SKETCH OF CORNER

CERTIFICATION

I, Rex O. Rice
certify that the information shown herein is true and correct.

Rex O. Rice

I, Alvah F. Hughes
certify that this Corner Record correctly represents work performed by me or under my direction in compliance with the "Corner Recordation Act" (70-22-101, et seq., M.C.A.)

Alvah F. Hughes
Signature of Surveyor & Seal

Date: 12/2/96

Reg. No.: 7322LS

Employer: U.S. FOREST SERVICE

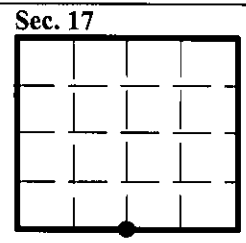

● - corner this sheet

Office of Clerk and Recorder, County of LINCOLN. This "corner record" was filed for record on FEB 3, 1997 and was noted on the cross-index plat and is assigned page No. 9123, in book No. _____.

CORAL M. CUMMINGS
County Official *By off*