

CERTIFIED LAND CORNER RECORDATION

$\frac{1}{4}$ Corner Sections 21 & 22 T. 30 N., R. 29 W., MPM

Record: (1964 BLM) Set an iron post, 30" long, 2 1/2" diam, 26" in the ground, with brass cap marked:

T. 30 N. R. 29 W.

S 21 | S 22
1964

From which:

A pine 14" diam, bears N 77 1/2° E, 28 lks dist.
A pine 14" diam, bears N 51° W, 25 lks dist.
Bury original stone alongside of iron post

Found: (1976) An iron post w/brass cap as described above and bearing trees as described. A mound of stone around pipe.

See certificate of survey # 213 for ties to adjacent corners.

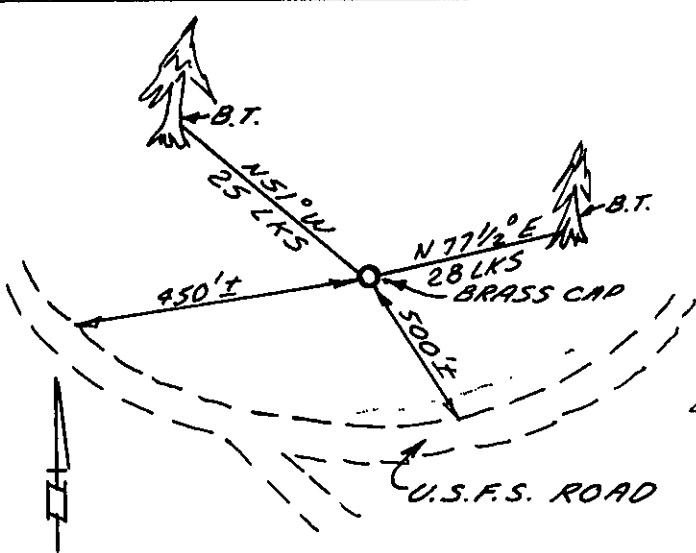

DIAGRAM OF CORNER

I, James R. Weatherly
certify that the information shown herein is true and correct.

[Signature]
Signature of Ground Party Chief

Gordon E. Sorenson

certify that I have carefully performed or reviewed the work done on the diagrammed corner as reported on this recordation form and approve the same.

[Signature]
Signature of Surveyor

5-24-76

Date

2345ES

Registration Number

SORENSON & COMPANY

Office of Clerk and Recorder, County of Lincoln

This "corner record" was filed for record on the 2nd day of June 19 76, was noted on the cross-index plat and is assigned page No. 463, in book No. 1

[Signature]
County Official

Cross Index No. P-13 T. 30 N R. 29 W Mer.