

# CERTIFIED LAND CORNER RECORDATION

Corner Sections 20, 21, 28 & 29 T. 30 N., R. 29 W. MPM

Record (1965 BLM) Set an iron post, 30" long, 2 1/2" diam, 26" in the ground, with brass cap mkd.

T. 30 N. R. 29 W.  
S 20 S 21  
S 29 S 28  
1965

From which:

A 20" diam stump, bears N 83 1/2°E, 66 lks dist, with fallen log mkd. T 30 N R 29 W S 21 BT

A stump hole, bears S 63°25'E 56 lks dist, with fallen log, no marks

A pine, 24" diam, bears S 43°20'W, 55 lks dist, with an overgrown blaze.

A pine, 20" diam, bears N 34 3/4°W, 17 lks dist, with an overgrown blaze.

A fir, 8" diam, bears N 36 3/4°E, 28 lks dist, mkd T30N R29W S21 BT

A pine, 9" diam, bears S 49°E, 54 lks dist, mkd T30N R29W S 28 BT

Bury the original stone alongside the iron post.

Found: (1976) an iron post with brass cap and bearing trees as described above.

See certificate of survey # 213 for ties to adjacent corners.

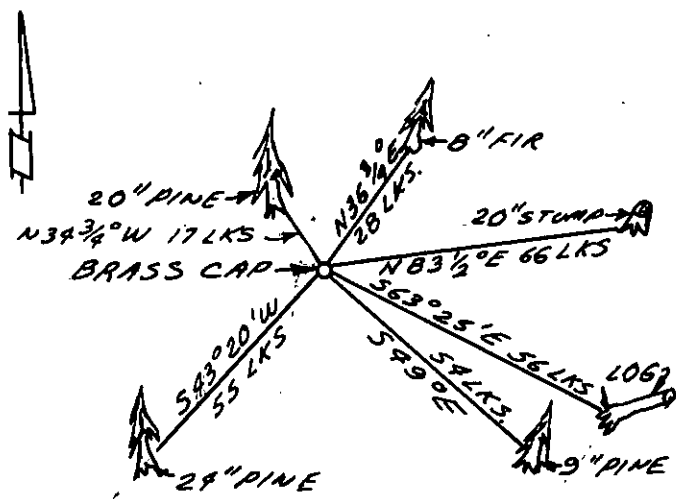

DIAGRAM OF CORNER

I, James R. Weatherly  
certify that the information shown herein is true and correct.

*[Signature]*  
Signature of Ground Party Chief

I, Gordon E. Sorenson  
certify that I have carefully performed or reviewed the work done on the diagrammed corner as reported on this recordation form and approve the same.

*[Signature]*  
Signature of Surveyor

5-21-76

Date

2345ES

Registration Number

SORENSEN & COMPANY

Office of Clerk and Recorder, County of Lincoln

This "corner record" was filed for record on the 22<sup>nd</sup> day of June 1976, was noted on the cross-index plat and is assigned page No. 462, in book No. 1. *[Signature]* County Official

Cross Index No. R-9 T. 30 N R. 29 W Mer.