

CERTIFIED LAND CORNER RECORDATION

1/4 Corner Section 21 & 28 T. 30 N., R. 29 W., MPM

Record: (1965 BLM) Set an iron post, 30" long, 2 1/2" diam, 26 ins. in the ground, with brass cap mkd.

T. 30 N. R. 29 W.
1/4 S 21
S 28
1965

From which:

A stump, 26" diam, bears N 30°20'E, 36 lks dist mkd 1/4 S 21 BT

A rotted stump, bears S 21°E, 83 lks dist, mkd illegibly

A larch, 10" diam, bears S 8 1/2°E, 59 lks dist mkd 1/4 S 28 BT

A larch, 11" diam, bears N 17°W, 124 lks dist, mkd 1/4 S 21 BT

Bury original stone alongside of iron post.

Found: (1976) Iron pipe w/brass cap & bearing trees as described in record notes.

See certificate of survey # 213 for ties to adjacent corners.

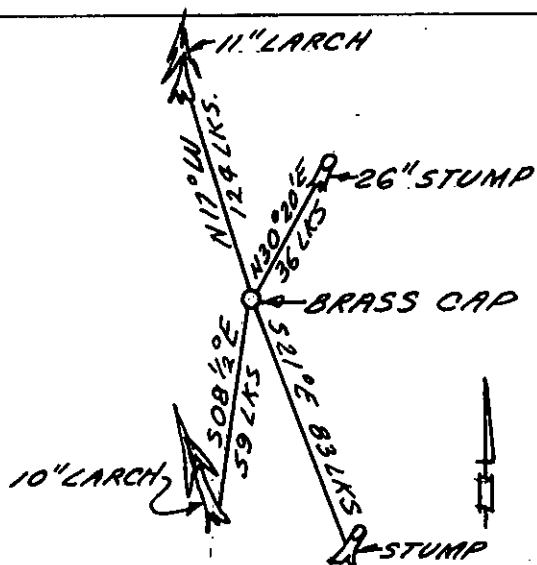

DIAGRAM OF CORNER

I, James R. Weatherly
certify that the information shown herein is true and correct.

Signature of Ground Party Chief

I, Gordon E. Sorenson
certify that I have carefully performed or reviewed the work done on the diagrammed corner as reported on this recordation form and approve the same.

Signature of Surveyor

5-21-76

Date

2345ES

Registration Number

BORENSON & COMPANY

Office of Clerk and Recorder, County of Lincoln

This "corner record" was filed for record on the 2nd day of June 1976, was noted on the cross-index plat and is assigned page No. 458, in book No. 1. Eleanor L. Vaughn, Mac Watson, Deputy County Official

Cross Index No. R-11 T. 30 N R. 29 W Mer.