

CERTIFIED LAND CORNER RECORDATION

Corner W 1/16th Corner Common to Sec. 21 & 28 T. 30 N, R. 29 W, MPM

Record: No known record

Set (1976): By proportion I determine the exact corner position and set a 2" iron pipe, 24" long, 22" in the ground with screw and washer marked:



From which:

A blazed and scribed 20" fir is 14.2 ft. dist, mkd RM
A blazed and scribed 20" fir is 40.2 ft. dist, mkd RM
corner is at the toe of fill on old skid trail

See certificate of survey # 213 for ties to adjacent corners.

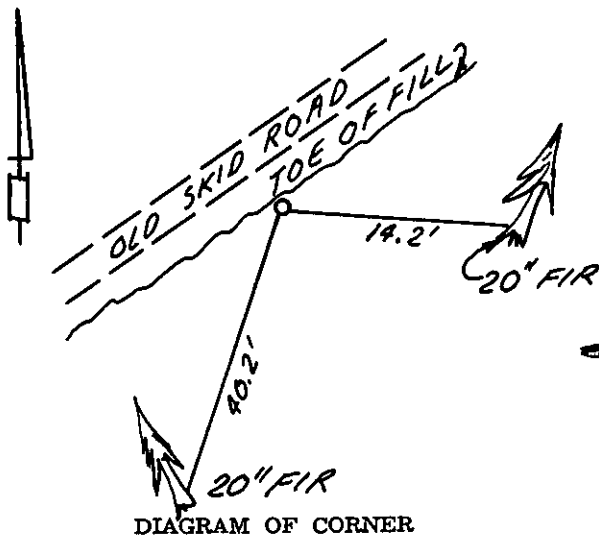

I, James R. Weatherly
certify that the information shown herein is true and correct.

[Signature]
Signature of Ground Party Chief

I, Gordon E. Sorenson
certify that I have carefully performed or reviewed the work done on the diagrammed corner as reported on this recordation form and approve the same.

[Signature]
Signature of Surveyor

5-21-76

Date

2345ES

Registration Number

SORENSON & COMPANY

Office of Clerk and Recorder, County of Lincoln

This "corner record" was filed for record on the 2nd day of June, 19 76, was noted on the cross-index plat and is assigned page No. 454, in book No. 1

[Signature]
County Official
R-10 30 N 29 W
Cross Index No. T. Mer.