

CERTIFIED CORNER RECORDATION

Corner NW 1/16 S2 T 30 N. R. 29 W. P.M.M. Lincoln County

I. Record: None

II. Found: No record monuments found.

III. Perpetuation: At the corner point, determined by survey, set a 5/8 ins. diam. steel rebar 28 ins. long, 27 ins. in the ground, with a 3 1/4 ins. diam. Aluminum cap marked as shown below from which:

A Douglas fir, 8ins. diam., bears N29°E, 16.84 ft. dist., scribed NW 1/16 S2 BT.

A Douglas fir, 10 ins. diam., bears S57°E, 9.07 ft. dist., scribed NW 1/16 S2 BT.

Painted faces and 6 in. wide red bands to all bearing trees and attached Land Survey Monument and Bearing Tree signs.

Set a 6 ft. steel post 3 ft. west from set monument with attached survey monument decal.

Magnetic declination: 18° East

Equipment used: Hand compass and loggers tape



NOTE: Refer to Certificate of Survey No. _____ Lincoln County Records for additional survey information.

Kootenai Surveyors Inc., 314 California Av., Libby, MT. 59923 (406) 293-4354

Kell - Dunn Creek

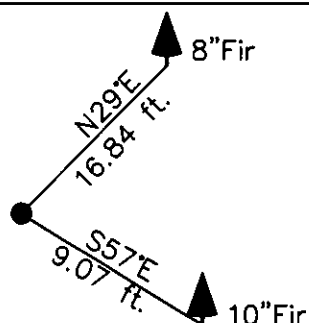

SKETCH OF CORNER

CERTIFICATION

I, Levi Powell
certify the information shown herein is true and correct.

[Signature]
Signature Ground Party Chief

I, Alvan P. Hughes
certify that this Corner Record correctly represents work performed by me or under my direction in compliance with the "Corner Recordation Act" (70-22-101, et seq., M.C.A.)

[Signature]
Signature of Surveyor & Seal

Date: 12/11/2013 Reg. No. 7322LS

Employer: Kootenai Surveyors Inc.

Office of Clerk and Recorder, County of Lincoln This "corner

record" was filed for re 248982 BOOK: CCR CC&R'S PAGE: 12096 Pages: 1

was noted on the cross STATE OF MONTANA LINCOLN COUNTY

book No. TAMMY D. LAUER CLERK AND RECORDER

FER: \$0.00

BY [Signature]

FOR: KOOTENAI SURVEYORS INC. P.O. BOX 393, LIBBY, MT 59923

Sec. 2

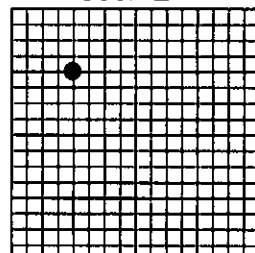

• corner this sheet

Cross Index No. B 18 T 30N R. 29W P.M., MT

Adopted July 1, 1981, Montana Board of Professional Engineers & Land Surveyors