

INSTRUCTIONS

1. Original and/or subsequent record used to evaluate the corner position.
2. Description of evidence found, note discrepancies in the record, state method of establishing lost or obliterated corners.
3. Description of monument and accessories set to perpetuate the corner position.
4. Sketch of corner, show all pertinent data which can best be shown in a sketch example, corner marking, topography ties, position of accessories, etc.
5. Certification must be signed and sealed by Land Surveyor registered in the State of Montana.
6. Fill in Cross Index & Section Diagram at bottom of sheet.

CERTIFIED CORNER RECORDATION

Corner E1/4 SEC. 9 T. 30N R. 29W P.M.M. Lincoln County

ORIGINAL:

Original Surveyor: Paul Bickel, year: 1898

- Set:** A slate stone, 20 x 12 x 6 ins. 15 ins. in the ground, for 1/4 Sec Cor. marked 1/4 on West face from which:
 A 14" diam fir, bears East 38 lks. dist. marked 1/4 S. 10 BT
 A 16" diam tamarack, bears S 65-40 W, 36 lks. dist. marked 1/4 S.9 BT

BLM: 1965

- Found:** The 1/4 sec. cor. Of secs. 9 and 10, monumented with a slate stone, 20 x 12 x 6 ins., firmly set, marked 1/4 on West side and witnessed by the remains of the original bearing trees.
 A 10" diam. Snag., bears N83E., 38 lks dis. Mkd 1/4 S
 A 12" diam. Larch, bears S65-40W., 36 lks. Dist., with an overgrown blaze
Set: Set an iron post, 30 ins. Long, 2 1/2" diam., 26" in the ground, with brass cap, from which:
 A 8" diam. Fir, bears N53 3/4E., 63 lks. Dist., mkd 1/4 S10 BT
 Bury the original stone alongside the iron post

FOUND:

- Found:** A 3 1/4" Brass cap protruding 0.70' above ground, leaning slightly to the South, with small rock mound.
 A 20" stump with visible scribing "BT" and no tag
 A 14" diam. Stump, TAG: 36 lks, N65 3/4E, T30N R29W, S9, 9-28-64

ESTABLISH:

- Set:** A 8" diam. Doug fir, bears: S15 1/2E, 103.28' dist., Scribed: 1/4 S10 BT, with BT tag
 A 7" diam. Doug fir, bears S57 3/4W, 3.16' dist., scribed: 1/4 S9 BT, with BT tag

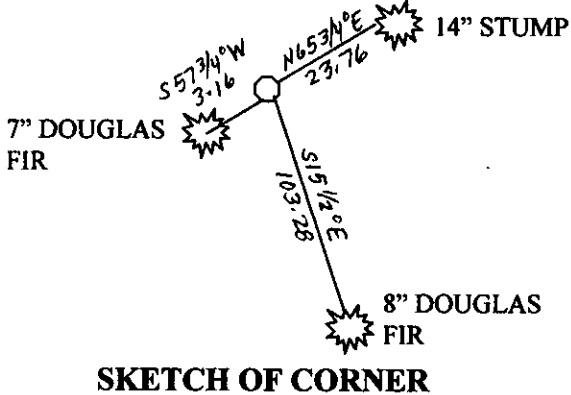
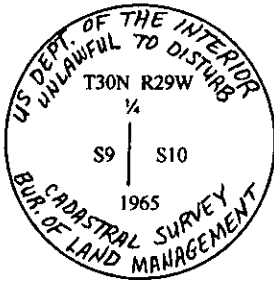

CERTIFICATION

I, James R. Staples
 Certify the information shown herein is true and correct.

James R. Staples
 Signature Ground Party Chief

I, James R. Staples
 certify that this Corner Record correctly represents work performed by me or under my direction in compliance with the "Corner Recordation Act" (70-22-101, et seq., M.C.A.)

James R. Staples
 Signature of Surveyor & Sealer

Date: 10/16/07 Reg. No. 9958L

Employer: J.R.S. Surveying, Inc.

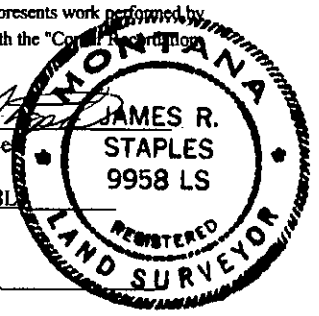

Office of Clerk and Recorder, County of _____ This "corner record" was filed for record on 206768 BOOK: CCR CC&R'S PAGE: 11138 Pages: 1
 STATE OF MONTANA LINCOLN COUNTY
 was noted on the cross-index pla RECORDED: 10/16/2007 9:19 KOI: CC&R'S
 TAMMY D. LAUER CLERK AND RECORDER
 book no. _____ FEE: \$0.00 BY: *Tammy D. Lauer* deputy
 TO: J.R.S. SURVEYING P.O. BOX 1050, LIBBY, MONTANA 59923
 County Official

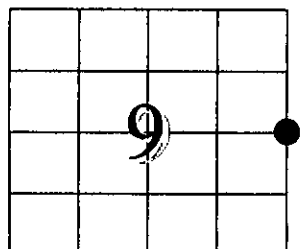

Cross Index No. G13 T. 30N R. 29W PMM