

## INSTRUCTIONS

1. Original and/or subsequent record used to evaluate the corner position.
2. Description of evidence found, note discrepancies in the record, state method of establishing lost or obliterated corners.
3. Description of monument and accessories set to perpetuate the corner position.
4. Sketch of corner, show all pertinent data which can best be shown in a sketch example, corner marking, topography ties, position of accessories, etc.
5. Certification must be signed and sealed by Land Surveyor registered in the State of Montana.
6. Fill in Cross Index & Section Diagram at bottom of sheet.

## CERTIFIED CORNER RECORDATION

Corner N1/4 SEC. 3 T. 30N R. 29W P.M.M. Lincoln County

## ORIGINAL:

## GLO - 1889 - Paul S.A. Bickel

Set a slate stone, 18x7x5 inches, 12 inches in the ground, for 1/4 Section Corner marked 1/4 on north face; from which:  
A Pine, 18 inches diameter, bears N50°E, 26 links (15.6 feet) distant, marked "1/4 S34 BT".  
A Fir, 8 inches diameter, bears S65.5°E, 52 links (34.32 feet) distant, marked "1/4 S3 BT".

## 1972 BLM

Set a 2 1/2" iron pipe with brass cap, marked as shown below, 24" in the ground; from which:  
A 22" Ponderosa Pine, bears N22°E, 60 links (39.60 feet) distant.  
A 6" Douglas Fir, bears S76 1/2°W, 15 links (9.90 feet) distant.

## FOUND:

Found a 3 1/2" BLM brass cap on 2 1/2" iron pipe, leaning to the south, marked as shown below. Accepted the BLM brass cap stamped "1972" as corner position.

Found "T" iron with one inch steel cap marked 1/4 corner, leaning to the northwest, bears N63 3/4°W, 1.06 feet from accepted monument.

Found original bearing tree stump, 16" diameter, with visible scribe, bears N46°E, 17.3 feet distant. (Record N50°E, 26 links (15.6 feet) distant per GLO 1889).

Found 12" Douglas Fir, with healed blaze and bearing tree tag, marked N76 1/2°E, 15 links (9.9 feet) distant by: ART 1970, bears S76°W, 9.9 feet distant (Record S76 1/2°W, 9.9 feet per BLM 1972).

Found 24" Ponderosa Pine, with visible scribing, bears N20 3/4°E, 40.8 feet distant (Record N22°E, 60 links (39.60 feet) distant per BLM 1972).

Attached bearing tree tags to existing bearing trees and blazes were painted red.

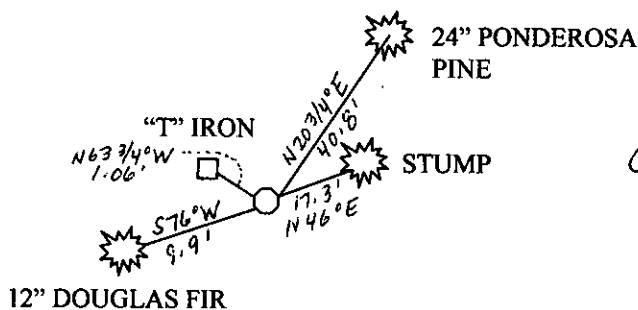
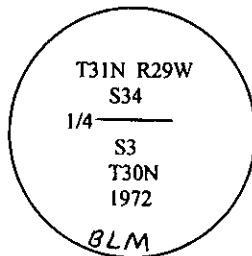

SKETCH OF CORNER

## CERTIFICATION

I, James R. Staples  
Certify the information shown herein is true and correct.

James R. Staples  
Signature Ground Party Chief

I, James R. Staples  
certify that this Corner Record correctly represents work performed by me or under my direction in compliance with the "Corner Recordation Act" (70-22-101, et seq., M.C.A.)

James R. Staples  
Signature of Surveyor & Sealer

Date: 10/16/07 Reg. No. 9958LS

Employer: J.R.S. Surveying, Inc.

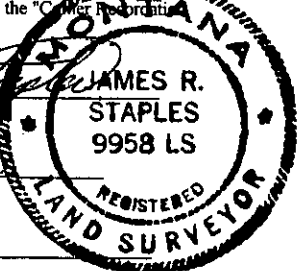

Office of Clerk and Recorder, County of

This "corner

206755 BOOK: CCR CC&R'S PAGE: 11125 Pages: 1

record" was filed for recor

STATE OF MONTANA LINCOLN COUNTY

was noted on the cross-ind

RECORDED: 10/16/2007 9:06 KOI: CC&R'S

book no. \_\_\_\_\_

TAMMY D. LAUER CLERK AND RECORDER

FEE: \$0.00

TO: J.R.S. SURVEYING P.O. BOX 1080, LIBBY, MONTANA 59923

County Official

Cross Index No. A15 T. 30N R. 29W PMM

Adopted July 1, 1981, Montana Board of Professional Engineers & Land Surveyors

• - Corner this sheet