

INSTRUCTIONS

1. Original and/or subsequent record used to evaluate the corner position.
2. Description of evidence found, note discrepancies in the record, state method of establishing lost or obliterated corners.
3. Description of monument and accessories set to perpetuate the corner position.
4. Sketch of corner, show all pertinent data which can best be shown in a sketch example, corner marking, topography ties, position of accessories, etc.
5. Certification must be signed and sealed by Land Surveyor registered in the State of Montana.
6. Fill in Cross Index & Section Diagram at bottom of sheet.

CERTIFIED CORNER RECORDATION

Corner N1/16 SEC.s 2 & 3 T. 30N R. 29W P.M.M. Lincoln County

The new corner monument was established as a result of a subdivisional survey of the Section. Said subdivisional survey was made in accordance with methods and procedures contained in the Manual of Surveying Instructions (1973); U.S. Bureau of Land Management.

ESTABLISHED:

Set a 3/4" aluminum cap on 5/8" x 30" rebar marked as shown below, flush with ground; from which:

An 8" Pine bears N12°W, 23.5 feet distant, blaze and scribe "N1/16 S3 BT".

A 7" Fir bears N37°E, 22.0 feet distant, blaze and scribe "N1/16 S2 BT".

Set a steel post, 2.0 feet north and a post 2.0 feet east of corner monument.

Bearing tree tags were attached to bearing trees and painted red.

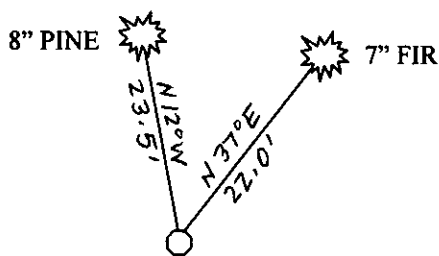

SKETCH OF CORNER

CERTIFICATION

I, James R. Staples
Certify the information shown herein is true and correct.

James R. Staples
Signature Ground Party Chief

I, James R. Staples
certify that this Corner Record correctly represents work performed by me or under my direction in compliance with the "Corner Recordation Act" (70-22-101, et seq., M.C.A.)

James R. Staples
Signature of Surveyor
Date: 10/16/07 Reg. No. 9958LS
Employer: J.R.S. Surveying, Inc.

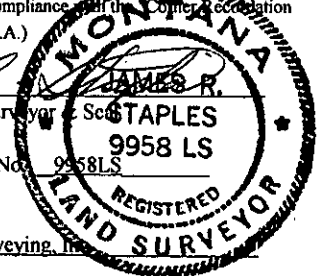

Office of Clerk and Recorder, County of _____ This "corner
record" was filed for record on 206750 BOOK: CCR CC&R'S PAGE: 11120 Pages: 1
was noted on the cross-index pla STATE OF MONTANA LINCOLN COUNTY
book no. RECORDED: 10/16/2007 9:00 KOI: CC&R'S
TAMMY D. LAUER CLERK AND RECORDER
FEE: \$0.00 BY: James R. Staples Deputy
TO: J.R.S. SURVEYING P.O. BOX 1050, LIBBY, MONTANA 59923

County Official

Cross Index No. B17 T. 30N R. 29W PMM

Adopted July 1, 1981, Montana Board of Professional Engineers & Land Surveyors

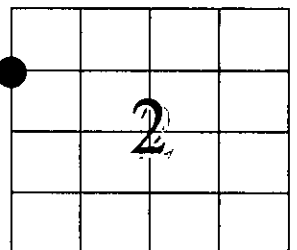

• - Corner this sheet