

# CERTIFIED CORNER RECORDATION

Corner NE COR. S29 T. 30 N. R. 29 W. P.M.M. LINCOLN County

I. Record: 1898 original GLO survey by P. Bickel, set a stone and four bearing trees.

1965 BLM Remoumentation by D. Lindenburg: Set an iron post, 30 ins. long, 2 1/2 ins. diam., 24 ins. in the ground, with brass cap mkd. as shown below from which:

- A stump, 20 ins. diam., bears N. 83°30' E., 66 lks. (43.56 ft.) dist., with fallen log with visible mks.
- A stump hole, bears S. 63°25' E., 56 lks. (36.96 ft.) dist., with fallen log, no mks.
- A pine, 24 ins. diam., bears S. 43°20' W., 55 lks. (36.30 ft.) dist., with overgrown blaze.
- A pine, 20 ins. diam., bears N. 34°45' W., 17 lks. (11.22 ft.) dist., with overgrown blaze.
- A fir, 8 ins. diam., bears N. 36°45' E., 28 lks. (18.48 ft.) dist., mkd. T30N R29W S21BT.
- A pine, 9 ins. diam., bears S. 49° E., 54 lks. (35.64 ft.) dist., mkd. T30N R29W S28 BT.

II. Found: A 3 1/4 ins. diam. BLM brass cap on a 2 1/2 ins. diam. iron pipe firmly set from which:

- A fir, 11 ins. diam., bears N. 35°30' E., 18.80 ft. with healed face.
- A fir snag, 9 ins. diam., bears S. 18° E., 17.30 ft. dist. with healed face.
- A pine snag, 26 ins. diam., bears S. 43° W., 33.90 ft. dist. with healed face.
- A pine, 24 ins. diam., bears N. 38° W., 10.70 ft. dist., with healed face.

III. Perpetuation: Establish two bearing trees described below:

- A fir, 13 ins. diam., bears S. 41°30' E., 78.30 ft. dist., mkd. T30N R29W S28 BT.
- A fir, 9 ins. diam., bears S. 62° W., 47.30 ft. dist., mkd. T30N R29W S29 BT.

Painted faces and 6 in. wide red bands to all bearing trees and attached bearing tree and Land Survey Monument signs.

Set a steel post with attached Property Line and Survey Monument stickers, 5.0 ft. West of found monument.

Magnetic declination: 18° East

Equipment used: Hand compass and loggers tape

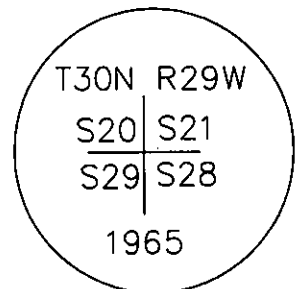

Kootenai Surveyors Inc., 314 California Av., Libby, MT. 59923 (406) 293-4354

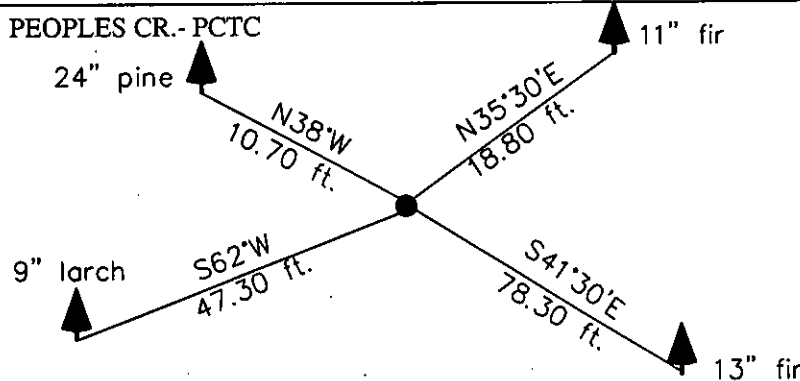

SKETCH OF CORNER

CERTIFICATION

I, Levi Powell  
 certify the information shown herein is true and correct.

Alvah F. Hughes  
 Signature of Ground Party Chief

I, Alvah F. Hughes  
 certify that this Corner Record correctly represents work performed by me or under my direction in compliance with the Corner Recordation Act, 40-22-101, et seq., M.C.A.

Alvah F. Hughes  
 Signature of Surveyor & Seal

Date: 6/17/2007 Reg. No. 7322-LS

Employer: Kootenai Surveyors Inc.

Office of Clerk and Recorder, County of Lincoln. This "corner

record" was filed for rec 205551 BOOK: CCR CC&R'S PAGE: 11099 Pages: 1

was noted on the cross STATE OF MONTANA LINCOLN COUNTY  
 RECORDED: 08/24/2007 8:44 KOI: CC&R'S

book No. TAMMY D. LAUER CLERK AND RECORDER

FEE: \$0.00

BY: Levi Powell

TO: AL HUGHES-SURVEYOR P.O. BOX 393, LIBBY MT 59923

Cross Index No. R 09 T. 30N R. 29W P.M., MT

Adopted July 1, 1981, Montana Board of Professional Engineers & Land Surveyors

Sec. 29

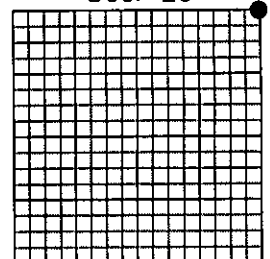

• corner this sheet