

CERTIFIED CORNER RECORDATION

Corner NE COR. S31 T 30 N. R. 29 W. P.M.M. LINCOLN County

I. Record: 1903 original GLO survey by Fessenden, set a stone and four bearing trees.

1966 BLM Remoumentation by D. Lindenburg: Set an iron post, 30 ins. long, 2 1/2 ins. diam., 24 ins. in the ground, with brass cap mkd. as shown below from which:

- A fir, 13 ins. diam., bears N. 22°30' E., 51 lks. dist., with overgrown blaze.
- A fir, 24 ins. diam., bears S. 48°E., 89 lks. dist., with visible scribes.
- A stump, bears S. 28°W., 29 lks. dist., no marks.
- A stump, bears N. 13°W., 50 lks. dist., mkd. T30N R29W S32 BT.
- A fir, 10 ins. diam., bears S. 17°15' E., 45 lks. dist., mkd. T30N R29W S31 BT.
- A larch, 9 ins. diam., bears N. 69°15' W., 72 lks. dist., mkd. T30N R29W S30 BT.

II. Found: A 3 1/4 ins. diam. BLM brass cap on a 2 1/2 ins. diam. iron pipe firmly set from which:

- A larch, 17 ins. diam., bears N. 69°W., 47.30 ft. with healed face.
- A fir, 19 ins. diam., bears S. 17°E., 29.70 ft. dist. with healed face.
- A larch, 9 ins. diam., bears S. 45°W., 61.38 ft. dist. with healed face.

III. Perpetuation: Establish one bearing tree described below:

A fir, 12 ins. diam., bears N. 55°E., 22.50 ft. dist., mkd. T30N R29W S29 BT.

Painted faces and 6 in. wide red bands to all bearing trees and attached bearing tree and Land Survey Monument signs.

Magnetic declination: 18° East

Equipment used: Hand compass and loggers tape

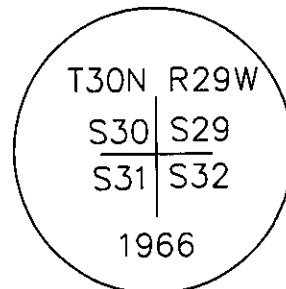

Kootenai Surveyors Inc., 314 California Av., Libby, MT. 59923 (406) 293-4354

BUCK CR. 07 - PCTC

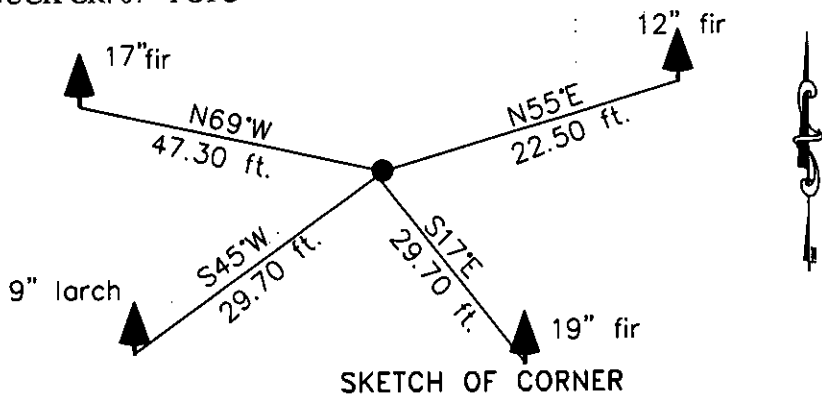

SKETCH OF CORNER

CERTIFICATION

I, Kelly Rooney certify the information shown herein is true and correct.

Kelly Rooney Signature Ground Party Chief

I, Alvah F. Hughes certify that this Corner Record correctly represents work performed by me or under my direction in compliance with the Corner Recordation Act (70-22-101, et seq., M.C.A.)

Alvah F. Hughes Signature of Surveyor & Seal

Date: 6/7/2007 Reg. No. 7322-LS

Employer: Kootenai Surveyors Inc.

Office of Clerk and Recorder, County of Lincoln This "corner

record" was filed for record on 205541 BOOK: CCR CC&R'S PAGE: 11089 Pages: 1

was noted on the cross-index STATE OF MONTANA LINCOLN COUNTY

book No. TAMMY D. LAUER CLERK AND RECORDER

FEE: \$0.00 BY: Alvah F. Hughes TO: AL HUGHES-SURVEYOR P.O. BOX 393, LIBBY MT 59923

Cross Index No. V 05 T. 30N R. 29W P.M., MT

Adopted July 1, 1981, Montana Board of Professional Engineers & Land Surveyors

Sec. 31

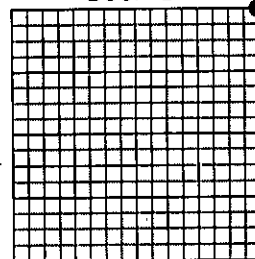

• corner this sheet