

CERTIFIED CORNER RECORDATION

Corner SOUTH 1/4 SECTION 27 T. 30N R. 29W P.M.M. LINCOLN County

FOUND: 3" B.L.M. BRASS CAP(STAMPED AS SHOWN) FROM WHICH:
A 11" FIR BEARS SOUTH 13.20 FEET WITH SCRIBE OVERGROWN
A 14" FIR BEARS N11°E 10.0 FEET WITH SCRIBING.

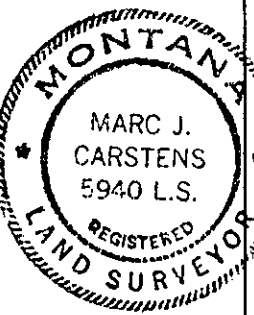
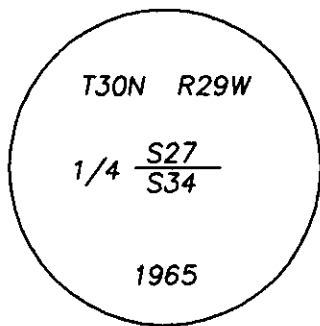
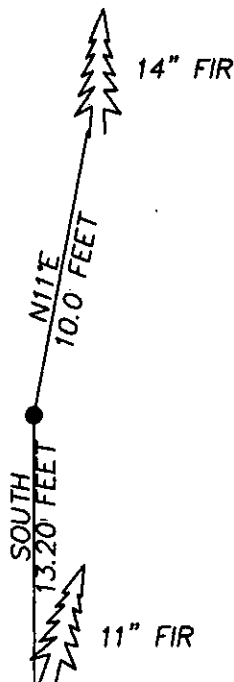

CERTIFICATION

I, DAN CROFT
certify the information shown herein is true and correct.

Dan Croft
Signature of Found Party Chief

MARC J. CARSTENS
certify that this Corner Record correctly represents work performed by me or under my direction in compliance with the "Corner Recordation Act" (70-22-101, et seq., M.C.A.)

Marc J. Carstens
Signature of Surveyor & Seal

Date: 04-29-04 Reg. No. 5940 L.S.

Employer: CARSTENS LAND SURVEYING

SKETCH OF CORNER

Office of Clerk and Recorder, County of LINCOLN. This 'corner record' was filed for record on Doc# 176044 5/10/04

was noted on the cross-index plat and is assigned page No. 10635, in doc book No. 176044

County Official

Cross Index No. V-15 T. 30N R. 29W PMM

Adopted July 1, 1981, Montana Board of Professional Engineers & Land Surveyors

Sec. 27

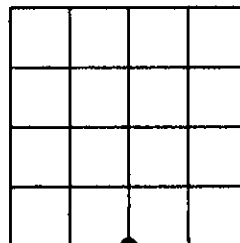

• corner this sheet