

-CERTIFIED CORNER RECORDATION

Corner 1/4 Secs. 18&19 T. 30N R. 29W P.M., MT Lincoln County

I. 1903 G.L.O. Record by George A. Fessenden et.al.: Set a slate stone, 14x7x6 ins., 9 ins. in the ground for 1/4 sec. cor., mkd. "1/4" on N. face.

Established two bearing trees:

- A fir, 6 ins. diam., bears N08 1/4°E, 42 lks. dist., mkd. "1/4 S18 BT".
- A fir, 6 ins. diam., bears S32°W, 110 lks. dist., mkd. "1/4 S19 BT".

1974 Certified Corner Recordation by John C. Erickson, 3979S: Found no evidence of the original stone, or the bearing trees. Reset corner by using single proportion method. At the corner position, set a Corps of Engineers brass cap, mkd. as shown.

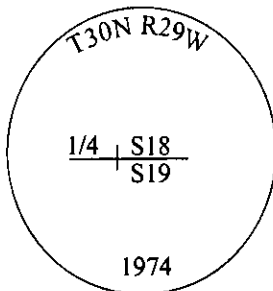

Established two new bearing trees, brass cap is 0.2 ft. downhill from large boulder, 2.0x3.0x1.0 ft. in diam.

II. Found a 1.0 in. diam. iron pipe, firmly set, protruding 4 ins. above ground, with a 3 1/2 in. diam., C.O.E brass cap, mkd. as shown. Found the reference boulder, 2x3x1 ft. diam., South, 0.2 ft. dist. of the corner.

from which:

- A fir, 12 ins. diam., bears S40°W, 16.5 ft. dist., with visible scribe. (COE-record)
- A fir, 10 ins. diam., bears N49°W, 24.4 ft. dist., with visible scribe. (COE-record-N39°W,-34 lks.-22.44 ft.)

III. Painted bearing trees and attached Land Survey Monument and Bearing Tree signs.

Magnetic Declination: 20° East

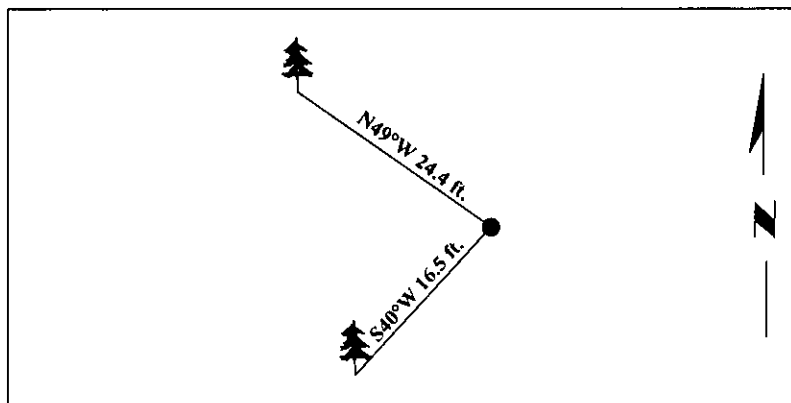

SKETCH OF CORNER

CERTIFICATION

I. Mark Federman
certify the information shown herein is true and correct.

Mark Federman

I. Steven A. Boyer
certify that this Corner Record correctly represents work performed by me or under my direction in compliance with the "Corner Recordation Act" (70-22-101, et seq., M.C.A.)

Steven A. Boyer
Signature of Surveyor & Seal

Date: 6/02/98

Reg. No.: 9750LS

Employer: U.S. FOREST SERVICE

Office of Clerk and Recorder, County of Lincoln. This "corner record" was filed for record on 8-19-98 and was noted on the cross-index plat and is assigned page No. 10165 in book No. _____.

Coral M. Cummins

 County Official

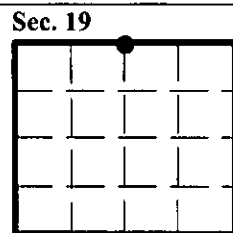

● - corner this sheet