

CERTIFIED CORNER RECORDATION

Corner Sec. Cor. Sec. 1 & 12 T. 30N R. 28W P.M., MT Lincoln County

- I. 1893 G.L.O. Original Record by James S. Keerl et. al.: Set a wooden post, 4 ft. long, 4 ins. square, 24 ins. in the ground, for cor to secs. 1,6,7&12, mkd. "T30N S6" on N.E., "R27W S7" on S.E., "R28W S12" on S.W., and "S1" on the N.W. faces, with 1 notch on the N. and 5 notches on the S. edges". Established four bearing trees.

1929 G.L.O. Resurvey of the W. Boundary of T30N, R27W by Ray D. Armstrong: For the newly established cor. of secs. 1 & 12, set an iron post, 3 ft. long, 2 ins. in diam., 28 ins. in the ground, with the brass cap mkd. as shown:

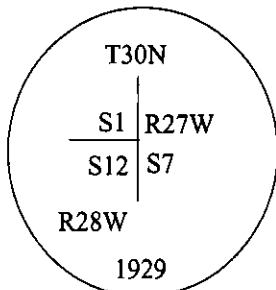

Established two new bearing trees.

- II. Found a 2 in. diam. pipe, protruding 9 ins. above the ground, firmly set, with a 2 1/2 in. diam. brass cap, mkd. as shown:

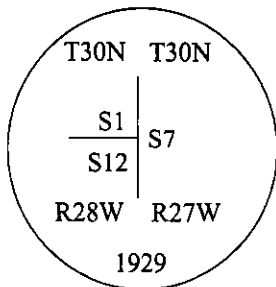

*Cap mkd. different than record.

from which:

A larch, 16 ins. diam., bears S82°W, 25.7 ft. dist., mkd. with a healed face. (record)
A down pine, 8 ins. diam., bears N67°W, 18.5 ft. dist., mkd. with a visible scribe. (record)

- III. Established one new bearing tree:
A cedar, 12 ins. diam., bears N45°W, 11.5 ft. dist., mkd., "T30N R28W S1 BT".

Painted bearing trees and attached Land Survey Monument and Bearing Tree signs.

Magnetic Declination: 20° East.

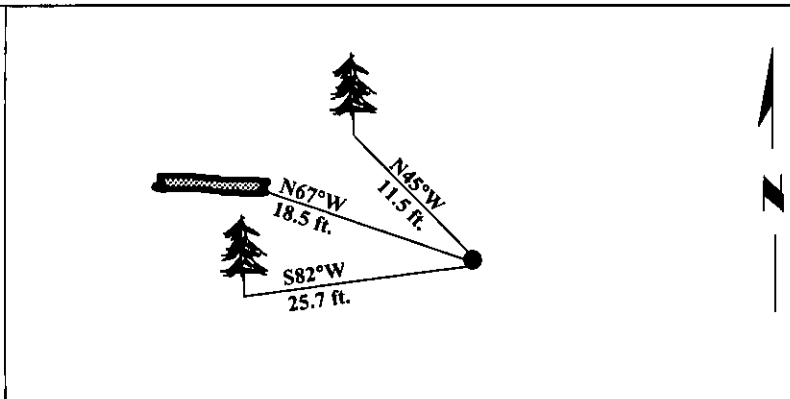
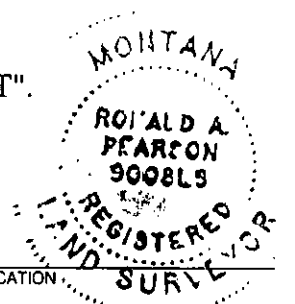

SKETCH OF CORNER

CERTIFICATION

I, Mark Federman
certify the information shown herein is true and correct.

I, Ronald A. Pearson
certify that this Corner Record correctly represents work performed by me or under my direction in compliance with the "Corner Recordation Act" (70-22-101, et seq., M.C.A.)

Signature of Surveyor & Seal

Date: 12/30/96

Reg. No.: 9008LS

Employer: U.S. FOREST SERVICE

Office of Clerk and Recorder, County of LINCOLN. This "corner record" was filed for record on FEB 3, 1997 and was noted on the cross-index plat and is assigned page No. 9085, in book No. CORAL M. CUMMINGS County Official [Signature]

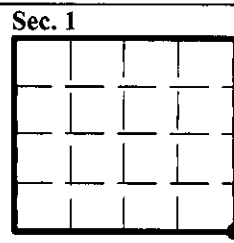

• - corner this sheet