

CERTIFIED CORNER RECORDATION

Corner Sec. Cor. Sec. 7 & 18 T. 30N R. 27W P.M., MT Lincoln County

I. 1893 G.L.O. Original Record by James S. Keerl et. al.: Set a limestone, 14x10x8 ins., 10 ins. in the ground, for cor. to secs. 7,12,13&18, mkd. with 4 notches on S. and 2 notches on the N. edges. Established four bearing trees.

1929 G.L.O. Retracement of W. Bdy. of T30N, R27W by Ray D. Armstrong et. al.: The cor. of secs. 7,12,13&18, which now refers to secs. 7 and 18 only, a limestone heretofore described. I destroy the markings on the bearing trees to the West.

1982 B.L.M. Remonumentation Record by Cruz D. Almanza: Found limestone, 14x10x8 ins., firmly set, 10 ins. in the ground, mkd. as described in the original record and witnessed by the remains of one original bearing tree. At the corner point, set an aluminum post, 30 ins. long, 2 1/2 ins. diam., 22 ins. in the ground, with the brass cap mkd. as shown:

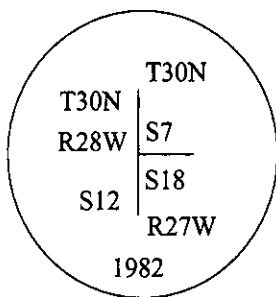

Established two new bearing trees, buried the original stone alongside and raise a collar of stone, 3 ft. diam., around the aluminum post.

II. Found a 2 1/2 in. diam. aluminum post, protruding 3 ins. above a rock collar, 3 ft.in diam., with a 3 1/4 in. diam. aluminum cap mkd. as shown above.

from which:

- A down pine, 6 ins. diam., bears N14°E, 21.8 ft. dist., mkd. with visible scribe. (Original-record)
- A larch, 19 ins. diam., bears N36°E, 33.6 ft. dist., mkd. with visible scribe. (BLM-record)
- A down pine, 6 ins. diam., bears S50°E, 4.6 ft. dist., mkd. with visible scribe. (Original-record)
- A larch, 18 ins. diam., bears S70°E, 46.2 ft. dist., mkd. with a healed face. (BLM-record)

III. Painted bearing trees and attached Land Survey Monument and Bearing Tree signs.

Magnetic Declination: 20° East.

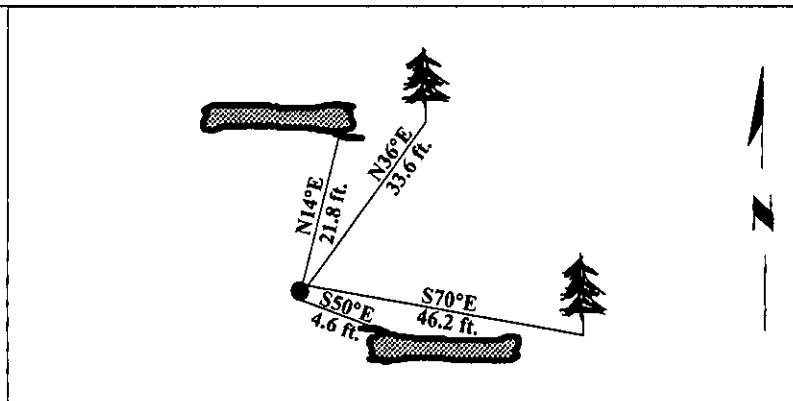

SKETCH OF CORNER

<p>CERTIFICATION</p> <p>I, <u>Mark Federman</u> certify the information shown herein is true and correct.</p> <p><i>Mark Federman</i></p>		<p>MONTANA</p> <p>RONALD A. PEARSON</p> <p>9008LS</p> <p>REGISTERED SURVEYOR</p>
<p>I, <u>Ronald A. Pearson</u> certify that this Corner Record correctly represents work performed by me or under my direction in compliance with the "Corner Recordation Act" (70-22-101, et seq., M.C.A.)</p> <p><i>Ronald A. Pearson</i></p> <p>Signature of Surveyor & Seal</p>		
<p>Date: <u>12/30/96</u></p> <p>Reg. No.: <u>9008LS</u></p> <p>Employer: <u>U.S. FOREST SERVICE</u></p>		

Office of Clerk and Recorder, County of LINCOLN. This "corner record" was filed for record on FEB 3, 1997 was noted on the cross-index plat and is assigned page No. 9094 in book No. _____

CORAL M. CUMMINGS County Official

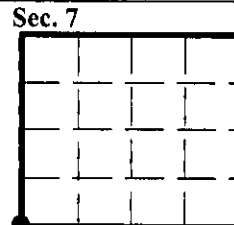

• - corner this sheet