

# CERTIFIED CORNER RECORDATION

Corner      Sec. Cor.      Sec.      4,5,8&9      T.      30N      R.      27W      P.M., MT      Lincoln      County

I.      1893 G.L.O. Original Record by James S. Keerl et. al.: Set a sandstone, 20x10x6 ins., 15 ins. in the ground, for cor. to secs. 4,5,8&9, mkd. with 5 notches on S. and 4 notches on the E. edges. Raise a mound of stone, 1 1/2 ft. high, 2 ft. base, alongside. No bearing trees established.

1966 B.L.M. Remonumentation Record by Roy G. Leedy: Found sandstone, 20x12x4 ins., firmly set, mkd. as described in the original record. At the corner point, set an iron post, 30 ins. long, 2 1/2 in diam., 18 ins. in the ground to bedrock and in a mound of stone, 3 ft. diam. to top, with brass cap mkd. as shown:

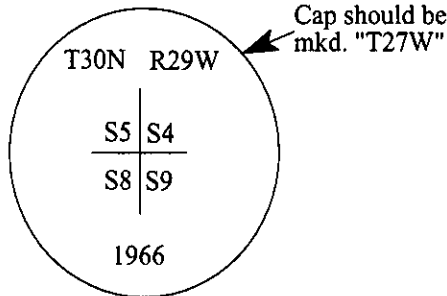

Established four bearing trees, buried the original stone alongside the iron post.

1981 Certified Corner Recordation by Melvin D. Lauteren, Reg. No. 4232-S: On file at the Lincoln County Courthouse, recorded on the 29th day of May, 1981, was assigned page No. 1027, in book No. 1.

II.      Found a 2 1/2 in. diam. iron pipe, protruding 7 ins. above the ground, firmly set, with a 3 1/4 in. diam. brass cap, mkd. as shown above.

from which:

- A larch, 13 ins. diam., bears N40°E, 21.8 ft. dist., mkd. with a healed face. (BLM-record)
- A larch, 15 ins. diam., bears S8°E, 24.4 ft. dist., mkd. with a healed face. (BLM-record)
- A down larch, 10 ins. diam., bears S33°W, 4.6 ft. dist., mkd. with visible scribe. (BLM-record)
- A larch, 14 ins. diam., bears N64°W, 13.2 ft. dist., mkd. with a healed face. (BLM-record)

III.      Established one new bearing tree:

A larch, 11 ins. diam., bears S6°W, 23.6 ft. dist., mkd. "T30N R27W S8 BT".

Painted bearing trees and attached Land Survey Monument and Bearing Tree signs.

Magnetic Declination: 20° East.

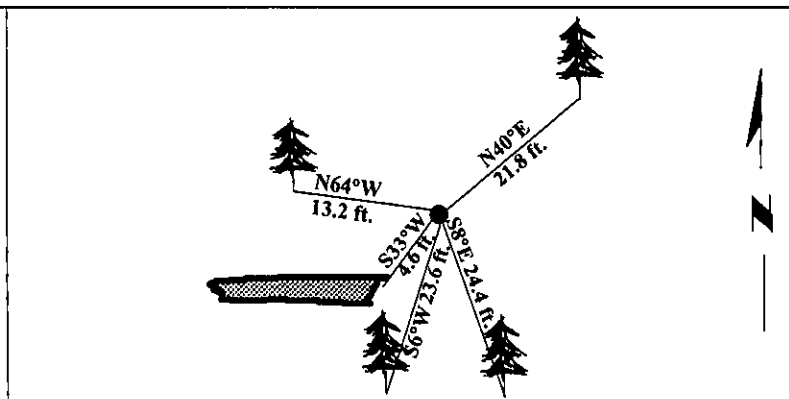

SKETCH OF CORNER

CERTIFICATION	
I. <u>Mark Federman</u>	certify the information shown herein is true and correct
<i>Mark Federman</i>	
I. <u>Ronald A. Pearson</u>	certify that this Corner Record correctly represents work performed by me or under my direction in compliance with the "Corner Recordation Act" (70S2-101, et seq., M.C.A.)
<i>Ronald A. Pearson</i>	
Signature of Surveyor & Seal	
Date: <u>12/30/96</u>	
Reg. No.: <u>9008LS</u>	
Employer: <u>U.S. FOREST SERVICE</u>	

Office of Clerk and Recorder, County of LINCOLN. This "corner record" was filed for record on FEB 3, 1997 and was noted on the cross-index plat and is assigned page No. 9092 in book No. \_\_\_\_\_.

CORAL M. CUMMINGS  
County Official

Sec. 9			

● - corner this sheet