

CERTIFIED CORNER RECORDATION

Corner 1/4 Sec. 7 & 18 T. 30N R. 27W P.M., MT Lincoln County

- I. 1893 G.L.O. Original Record by James S. Keerl et. al.: Set a granite stone, 14x12x10 ins., 10 ins. in the ground, for 1/4 sec. cor. of secs. 7 & 12, mkd. "1/4" on the N. face.

from which:

A pine, 3 ins. diam., bears N39°E, 20 lks. dist., mkd. "1/4 S BT".
A pine, 3 ins. diam., bears S14°W, 15 lks. dist., mkd. "1/4 S BT".

1982 B.L.M. Remonumentation Record by Cruz D. Almanza: Found granite stone, 14x12x10 ins., firmly set, 10 ins. in the ground, mkd. "1/4" on the N. face and witnessed by the remains of one original bearing tree. At the corner point, set an aluminum post, 30 ins. long, 2 1/2 ins. diam., 22 ins. in the ground, with the aluminum cap mkd. as shown:

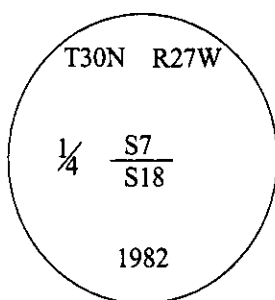

Established two new bearing trees, buried the original stone alongside and raised a collar of stone, 3 ft. diam., around the aluminum post.

- II. Found a 2 1/2 in. diam. aluminum pipe, protruding 9 ins. above the ground, firmly set, with a 3 1/4 in. diam. aluminum cap mkd. as shown above.

from which:

A larch, 18 ins. diam., bears N13°E, 29.7 ft. dist., mkd. with a healed face. (BLM-record)
A larch, 16 ins. diam., bears S44°W, 25.74 ft. dist., mkd. with a healed face. (BLM-record)
Found no evidence of GLO bearing trees.

- III. Painted bearing trees and attached Land Survey Monument and Bearing Tree signs.

Magnetic Declination: 20° East.

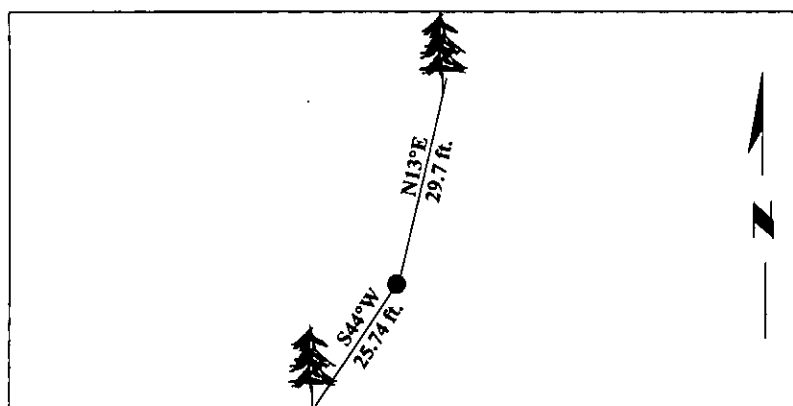

SKETCH OF CORNER

CERTIFICATION

I, Mark Federman certify the information shown herein is true and correct.

Mark Federman SURVEYOR

I, Ronald A. Pearson certify that this Corner Record correctly represents work performed by me or under my direction in compliance with the "Corner Recordation Act" (70-22-101, et seq., M.C.A.)

Ronald A. Pearson Signature of Surveyor & Seal

Date: 12/30/96

Reg. No.: 9008LS

Employer: U.S. FOREST SERVICE

Office of Clerk and Recorder, County of LINCOLN. This "corner record" was filed for record on FEB 3, 1997 and was noted on the cross-index plat and is assigned page No. 9090, in book No. _____.

CORAL M. CUMMINGS County Official

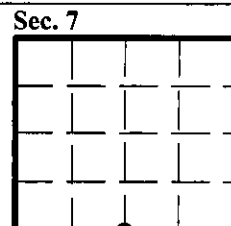

● - corner this sheet