

Corner	Sec. Cor.	Sec. 7,8,17 &18	T. 30N	R. 27W	P.M., MT	Lincoln	County
--------	-----------	--------------------	--------	--------	----------	---------	--------

- 1982 B.L.M. Remonumentation Record by Cruz D. Almanza: Found granite stone 15x12x10 ins., firmly set, 10 ins. in the ground, mkd. as described in the original record and witnessed by a mound of stone, 2 ft. base, 1 1/2 ft. high, alongside. At the corner point, set an aluminum pipe, 30 ins. long, 2 1/2 ins. diam., 22 ins. in the ground, with a 3 1/4 in. diam. aluminum cap mkd. as shown:

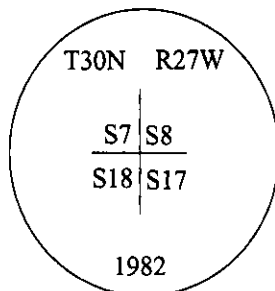

II. Found a 2 1/2 in. diam. aluminum pipe, protruding 3 ins. above the ground, firmly set in a collar of stone, with a 3 1/4 in. diam. aluminum cap mkd. as shown above.

A larch, 14 ins. diam., bears N27°E, 54.8 ft. dist., mkd. with a healed face. (record)
 A larch, 22 ins. diam., bears S46°E, 23.8 ft. dist., mkd. with a healed face. (record)
 A larch, 19 ins. diam., bears S60°W, 19.8 ft. dist., mkd. with a healed face. (record)
 A larch, 16 ins. diam., bears N54°W, 45.5 ft. dist., mkd. with a healed face. (record)

- III. Painted bearing trees and attached Land Survey Monument and Bearing Tree signs.

Magnetic Declination: 20° East.

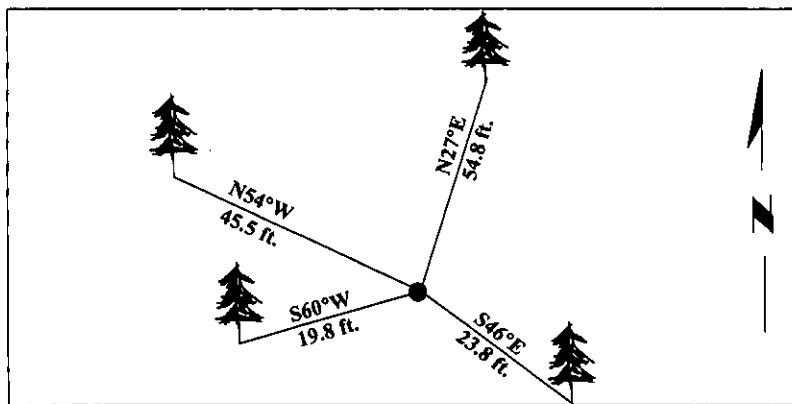

SKETCH OF CORNER

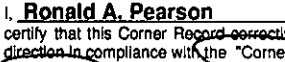
1. **Mark Federman**
certify the information shown herein is true and correct.

I, **Ronald A. Pearson**
certify that this Corner Record ~~correctly~~ represents work performed by me or under my
direction in compliance with the "Corner Recordation Act" (70-22-101, et seq., M.C.A.)

Signature of Surveyor & Seal
Date: 12/30/96
Reg. No.: 9008LS
Employer: U.S. FOREST SERVICE

Office of Clerk and Recorder, County of LINCOLN. This "corner record" was filed for record on FEB 3, 1997 and was noted on the cross-index plat and is assigned page No. 9089, in book No. CORAL M. CUMMINGS *By PLA*

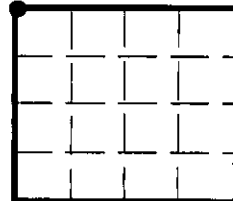
County Official

Sec. 17



● - corner this sheet