

# CERTIFIED CORNER RECORDATION

Corner 1/4 Sec. 20 & 21 T. 30N R. 27W P.M., MT Lincoln County

- I. 1893 G.L.O. Original Record by James S. Keerl et. al.: Set a wooden post, 3 ft. long, 3 ins. square, 24 ins. in the ground, for 1/4 sec. cor., mkd. "1/4 S" on the W. face.

Established two bearing trees:

A pine, 5 ins. diam., bears East, 18 lks. dist., mkd. "1/4 S BT".  
A pine, 4 ins. diam., bears S30 1/4°W, 16 lks. dist., mkd. "1/4 S BT".

1971 B.L.M. Remonumentation Record by Joseph E. French: The 1/4 sec. cor. of secs. 20 and 21, determined by the the remains of the original bearing trees. At the corner point, set an iron post, 30 ins. long, 2 1/2 ins. diam., 24 ins. in the ground, with brass cap mkd. as shown:

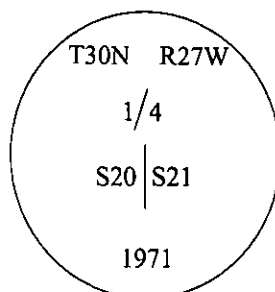

Established one new bearing tree:

A larch, 11 ins. diam., bears N40 1/2°W, 44 lks. dist., mkd. "1/4 S20 BT".

Raise a flat mound of stone, 3 1/2 ft. base, around the iron post.

- II. Found a 2 1/2 in. iron pipe, protruding 1 in. above a collar of stone, firmly set, with brass cap mkd. as shown above.

from which:

A fallen pine, bears East, 11.9 ft. (18 lks.) dist., mkd. with visible scribe.  
A larch, 11 ins. diam., bears West, 10.7 ft. dist., mkd. with visible scribe. (no record)  
No evidence found of the GLO section 21 bearing tree.  
A larch, 13 ins. diam., bears N40°W, 29.6 ft. dist., mkd. with a healed face.

- III. Painted bearing trees and attached Land Survey Monument and Bearing Tree signs.

Magnetic Declination: 20° East.

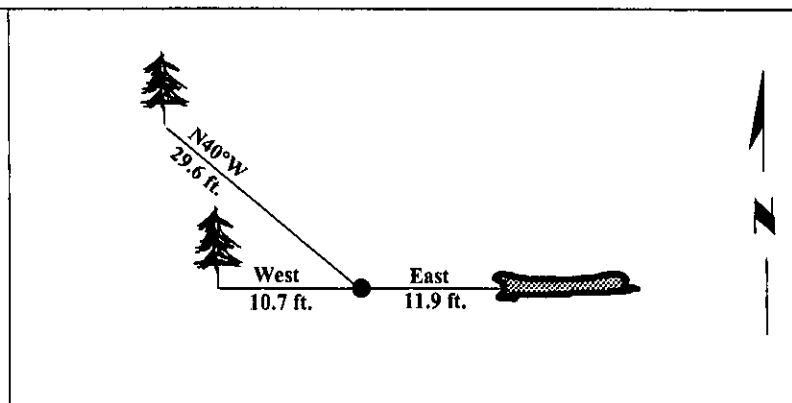

SKETCH OF CORNER

CERTIFICATION

I, Rex O. Rice  
certify the information shown herein is true and correct.

Rex O. Rice  
Signature of Surveyor & Seal

I, Ronald A. Pearson  
certify that this Corner Record correctly represents work performed by me or under my direction in compliance with the "Corner Recordation Act" (70-22-101, et seq., M.C.A.)

Ronald A. Pearson  
Signature of Surveyor & Seal

Date: 12/31/96

Reg. No.: 9008LS

Employer: U.S. FOREST SERVICE

Office of Clerk and Recorder, County of LINCOLN. This "corner record" was filed for record on FEB 3, 1997 and was noted on the cross-index plat and is assigned page No. 9082 in book No.                     .

CORAL M. CUMMINGS  
County Official

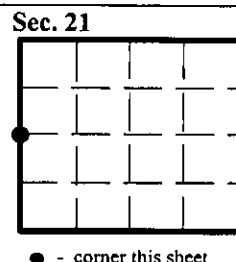

● - corner this sheet

Cross Index No. P-09 T. 30N R. 27W P.M., MT