

CERTIFIED CORNER RECORDATION

CORNER SE CORNER SEC. 35 T. 30N , R. 27W , P.M.M., LINCOLN COUNTY

FOUND: 3 1/4" B.L.M. BRASS CAP STAMPED AS SHOWN, FROM WHICH;
 31" PINE BEARS N40°E, 85.80' SCRIBE OVERGROWN.
 30" PINE BEARS N04°W, 77.20' SCRIBE OVERGROWN.

MAINTENANCE: REMOVED BRUSH AND TREE LIMBS FROM CORNER AREA.
 SET STEEL POST 1 FOOT WEST, PAINTED RED BANDS ON BT'S.
 ALL BEARING TREES HAVE BT TAGS ATTACHED.

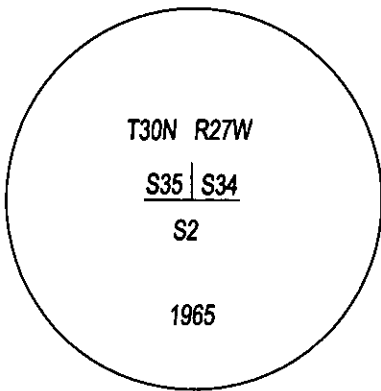
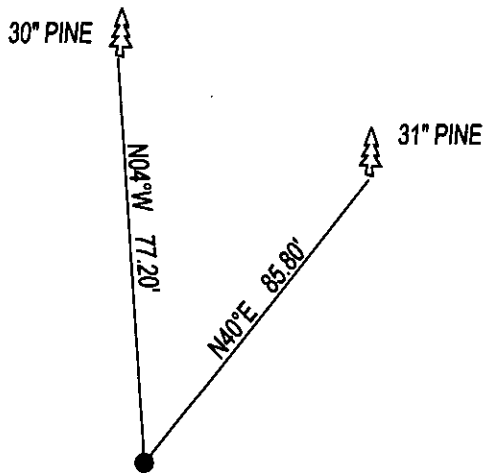

SKETCH OF CORNER

CERTIFICATION

I, DAN CROFT
 CERTIFY THE INFORMATION SHOWN HEREIN IS TRUE AND CORRECT.

SIGNATURE GROUND PARTY CHIEF

I, MARC J. CARSTENS
 CERTIFY THAT THIS CORNER RECORD CORRECTLY REPRESENTS WORK PERFORMED BY ME OR UNDER MY DIRECTION IN COMPLIANCE WITH THE "CORNER RECORDATION ACT" (70-22-101, ET SEQ., M.C.A.)

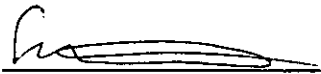

SIGNATURE OF SURVEYOR & SEAL

11-26-2014

DATE

CARSTENS SURVEYING

EMPLOYER

5940LS
 REG. NO.

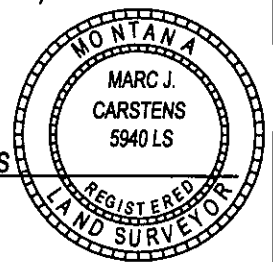

254823 BOOK: CCR CC&R'S PAGE: 12158 Pages: 1
 STATE OF MONTANA LINCOLN COUNTY
 RECORDED: 11/28/2014 10:32 KOI: CC&R'S
 TAMMY D. LAUER CLERK AND RECORDER
 FEE: \$0.00 BY: Robert A. Benson, Deputy
 FOR FILED

COUNTY OFFICIAL

CROSS INDEX NO. Z-21 T. 30N , R. 27W , P.M.M.

ADOPTED JULY 1, 1981, MONTANA BOARD OF PROFESSIONAL ENGINEERS & LAND SURVEYORS

SEC. 35

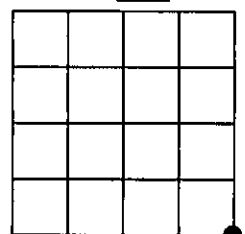

● CORNER THIS SHEET