

# CERTIFIED CORNER RECORDATION

Corner SE CORNER SEC. 17 T. 30N R. 27W P.M.M. County LINCOLN

FOUND: 3 1/4" BRASS CAP STAMPED AS SHOWN, FROM WHICH:  
 21" TAMARACK BEARS N42°E 22.40' SCRIBE OVERGROWN.  
 11" LODGEPOLE BEARS S76°E 41.30' SCRIBE OVERGROWN.  
 26" TAMARACK BEARS S08°W 57.80' SCRIBE OVERGROWN.  
 11" TAMARACK BEARS 70°W 21.80' WITH SOME SCRIBE.

MAINTENANCE: REMOVED BRUSH FROM CORNER AREA. SET 5 FOOT STEEL POST NORTH OF CORNER ATTACHED BY TAGS AND PAINTED A RED 6" BAND AND SCRIBE RED

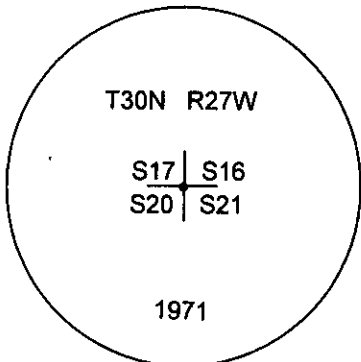
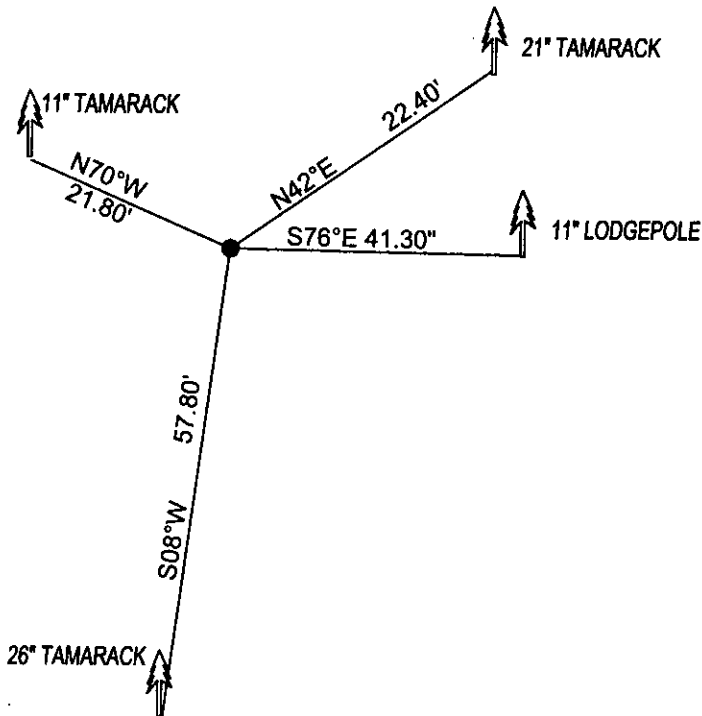

SKETCH OF CORNER

CERTIFICATION

I, DAN CROFT  
 certify the information shown herein is true and correct.

Signature Ground Party Chief

I, MARC J. CARSTENS  
 certify that this Corner Record correctly represents work performed by me or under my direction in compliance with the "Corner Recordation Act" (70-22-101, et seq., M.C.A.)

Signature of Surveyor & Seal

Date: 10-2012 Reg. No. 5940 LS

Employer: CARSTENS LAND SURVEYING



Office of Clerk and Recorder, County of LINCOLN This "corner

record" was filed for record on 241257 BOOK: CCR CC&R'S PAGE: 11986 Pages: 1

STATE OF MONTANA LINCOLN COUNTY  
 was noted on the cross-index plat RECORDED: 10/12/2012 11:30 KOI: CC&R'S

TAMMY D. LAUER CLERK AND RECORDER

book No. \_\_\_\_\_ FEE: \$0.00

BY: *[Signature]*

FOR: CARSTENS LAND SURVEYING P.O. BOX 1374, POLSON, MONTANA

Cross Index No. N-09 T. 30N R. 27W PMM

Sec. 17
