

CERTIFIED LAND CORNER RECORDATION

DESCRIPTION OF CORNER EVIDENCE FOUND, AND ORIGINAL RECORD (IF KNOWN)

1893 ORIGINAL RECORD - Set a sandstone 14X10X6 ins., 10 ins. in the ground for cor. to secs. 4, 5, 32, and 33, marked with 2 notches on W. and 4 notches on E. edges; from which:

A Tamarack, 32 ins. diam., bears N. 40° E., 70 lks. dist. marked T31N, R27W, S.33 BT.

A Tamarack, 26 ins. diam., bears S. 33° E., 39 lks. dist. marked T30N, R27W, S.4 BT.

A Tamarack, 18 ins. diam., bears S. 65° W., 26 lks. dist., marked T30N, R27W S.5 BT.

SEE REVERSE

DESCRIPTION OF MONUMENT AND ACCESSORIES ESTABLISHED TO PERPETUATE THE ORIGINAL LOCATION OF THIS CORNER:

Date of work: 5/7/81

NONE

SKETCH, WITH COURSE AND DISTANCE TO ADJACENT CORNERS IF DETERMINED IN THIS SURVEY. (MAY SKETCH OR PASTE REPRODUCTION ON REVERSE SIDE.)

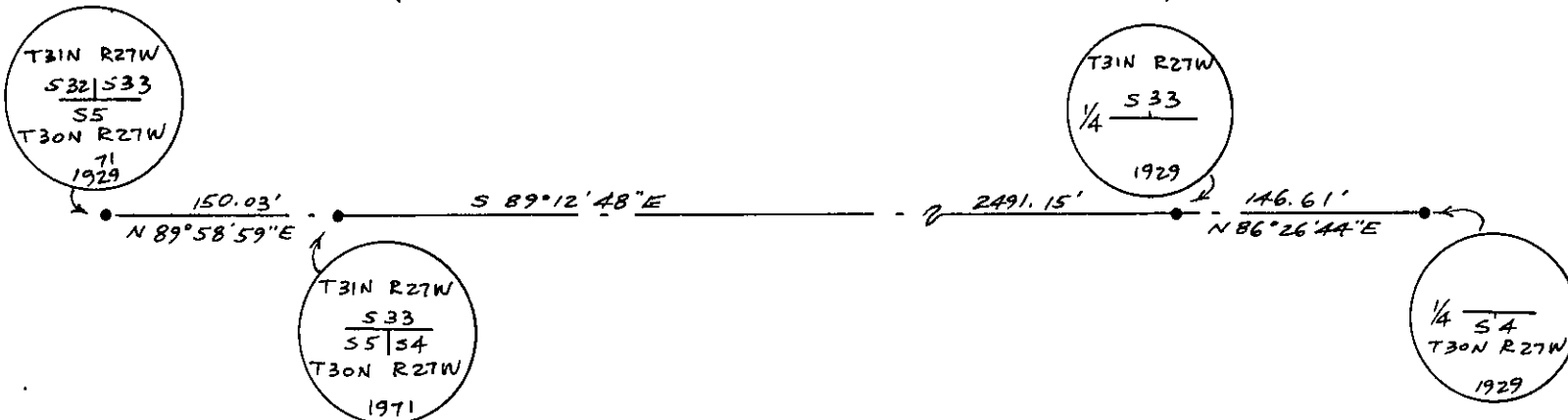

Surveyor's Seal



I, L.A. Dolezal

certify that the information shown herein is true and correct.

L.A. Dolezal
Signature of Ground Party Chief

I, Melvin D. Lauteren

certify that I have carefully performed or reviewed the work done on the diagrammed corner as reported on this recordation form and approve the same.

Melvin D. Lauteren
Signature of Surveyor

DIAGRAM OF CORNER:

SECTION 4
N. T30N, R27W, PMM

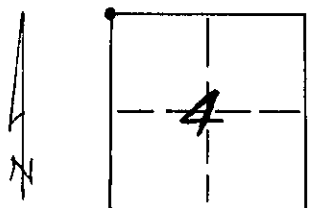

• = Corner recorded on the sheet
NW CORNER OF
SECTION 4
T30N, R27W, P.M.M.

4232-5
Registration Number

Office of Clerk and Recorder, County of Lincoln

This "corner record" was filed for record on the 29th day of May, 1981, was noted on the cross-index plat and is assigned page No. 1023, in book No. 1

Clarence L. Vaughn, Jr. Deputy
County Official

A Tamarack, 24 ins. diam., bears N. 19° W., 50 lks. dist. marked T31N, R27W S.32 BT.

1929-Found sandstone, 6X4X4 ins. above ground, marked and witnessed as noted above. This corner hereafter to refer to Secs. 4 and 5, only, therefore, erase markings on the NE. and NW. bearing trees.

1971-Found sandstone 14X10X6 ins., set 10 ins. in the ground, mkd. 2 notches on the W. and 4 notches on the E. edges from which remains of the original bearing trees:

A Larch snag, 18 ins. diam., bears S. 33° E., 39 lks. dist., mkd. T30N, R27W, S.4. BT.

A Matured Larch, 22 ins. diam., bears S. 65° W., 26 lks. dist., mkd. with an overgrown blaze

At the corner point, set an iron post, 30 ins. long, 2 1/2 ins. diam., 24 ins. in the ground, with brass cap marked.

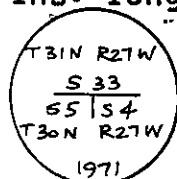

from which new bearing trees:

A Fir, 7 ins. diam., bears S. 71 3/4 ° E., 49 lks. dist., mkd. T30N, R27W S.4 BT.

A Larch, 7 ins. diam., bears S. 70 1/2 ° W., 77 lks. dist., mkd. T30N R27W S.5 BT.

bury the original stone alongside the iron post.

1981 Found Monument and Bearing Trees per 1971 record notes in place, with grown over blaze per 1971 notes on matured Larch original bearing tree and no evidence of Larch Snag original bearing tree. The matured Larch bears S. 65° W., 16.7 feet dist., instead of the record 26 lks. dist., and the original Larch snag is now laying on its side with visible marks "27" on a portion of the old blaze that was opened previously.