

CERTIFIED CORNER RECORD

Corner CC Sec. Cor. 17 ^{8/9} T. 30 N., R. 26 W., P.M.M. Lincoln County

Record :

1932 GLO Survey by Lyman.

"Set an iron post, 3 ft. long, 2 ins. diam., 28 ins. in the ground, for the closing corner of Secs. 8 and 9 only, with brass cap, from which:

A pine, 8 ins. diam., bears N 79 1/4° E, 74 lks. dist., marked T30N R26W S9 CC BT".

A pine, 9 ins. diam., bears N 30° W, 56 lks. dist., marked T30N R26W S8 CC BT".

Found Evidence :

A 2 inch dia. iron pipe with a 2 1/2 inch dia. brass cap marked as shown below, 8 ins. exposed above ground and slightly bent from past logging activities, from which:

A Lodgepole snag fallen over with visible scribing bears N 30° W, 56 lks. dist.

Two (2) Bearing Trees, origin unknown.

A Larch 21 1/2 ins. dia. bears N 58°30' W, 72 lks. dist., with visible scribing.

A Larch 10 3/4 ins. dia. bears N 10° E, 48.40 ft. dist., with overgrown face.

Perpetuation :

Painted scribed faces red and 6 inch wide bands around the Bearing Trees and attached Land Survey Monument and Bearing Tree signs where needed.

Set a steel guard post 2.50 ft. on line N of corner with attached Land Survey Monument and Property Line stickers.



Magnetic Declination: 18° East

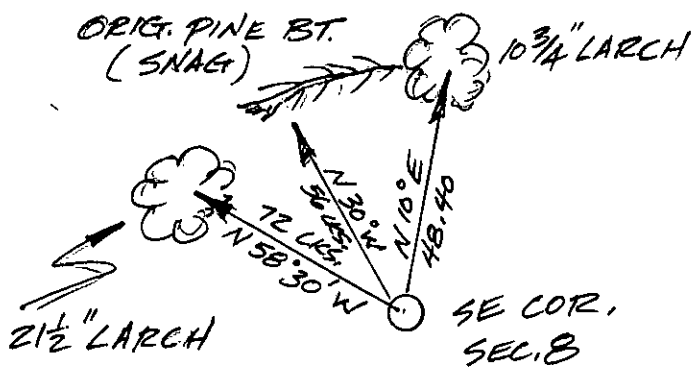

Sketch of Corner

CERTIFICATION

I, John Damon

certify the information shown herein is true and correct

John Damon

Signature of Ground Party Chief

I, Ken E. Davis

certify that this Corner Record correctly represents work performed by me or under my direction in compliance with the "Corner Recoration Act"

Ken E. Davis

Signature of Surveyor & Seal

Date: 10/13/97 Reg. No. 4975-S

Employer: _____

Office of Clerk and Recorder, County of Lincoln

This "corner record" was filed for record on Oct 14, 1997
was noted on the cross-index plat and is assigned page No. 9985
in book No. _____

Carol M. Cumming by OLB
County Official

Section

T30N R26W
SEC. 8

Cross Index No. CC S Cor. 17 ^{8/9} T. 30 N., R. 26 W., PMM

• THIS CORNER