

CERTIFIED CORNER RECORDATION

Corner 1/4 Sec. 2&35 T. 30N R. 26W P.M., MT Lincoln County

I. 1893 G.L.O. Original Record by James S. Keerl et. al.: Set a limestone, 16x10x5 ins., 11 ins. in the ground for 1/4 sec. cor. mkd. "1/4" on the N. face.

Established two bearing trees:

- A fir, 10 ins. diam., bears N32°E, 42 lks. dist., mkd. "1/4 S BT".
- A fir, 6 ins. diam., bears S27°W, 16 lks. dist., mkd. "1/4 S BT".

1965 B.L.M. Remonumentation Record by Duane C. Lindenberg: The 1/4 sec. cor of secs. 2 and 35, on the S. boundary of the Tp., determined from the remains of the original bearing trees. At the corner position, set an iron post, 30 ins. long, 2 1/2 ins. in diam., 26 ins in the ground, with brass cap mkd. as shown:

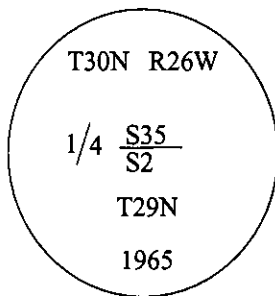

Established two new bearing trees:

- A fir, 14 ins. diam., bears S62°W, 57 lks. dist., mkd. "1/4 S2 BT".
- A fir, 12 ins. diam., bears N54°W, 39 lks. dist., mkd. "1/4 S35 BT".

1983 Certified Corner Recordation by William Condrey No. 5425-S: Found corner and bearing trees as described in the BLM record, in good condition.

II. Found a 2 1/2 in. diam. iron pipe, flush with rock, firmly set, with a 3 1/4 in. diam. brass cap mkd. as shown above.
from which:

- A fir, 14 ins. diam., bears S62°W, 38.0 ft. dist., with a burned face. (BLM-record mkd. "1/4 S2 BT".)
- A fir, 12 ins. diam., bears N54°W, 26.0 ft. dist., mkd. with a healed face. (BLM-record mkd. "1/4 S35 BT".)

III. Established one new bearing tree:

- A larch, 28 ins. diam., bears S45°W, 19.0 ft. dist., mkd. "1/4 S2 BT".

Painted bearing trees and attached Land Survey Monument and Bearing Tree signs.

Magnetic Declination: 20° East.

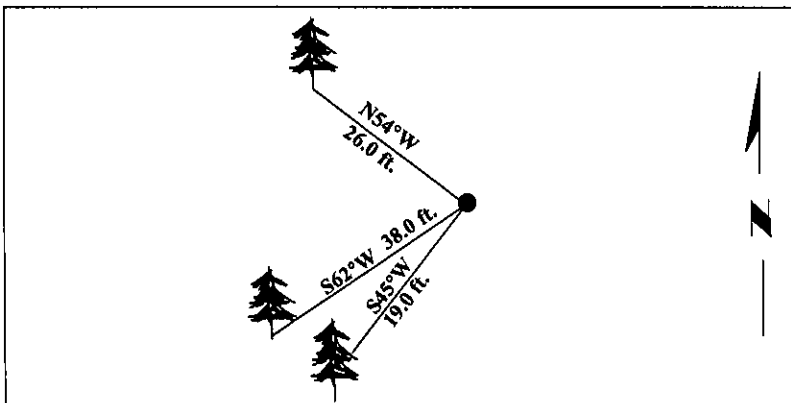
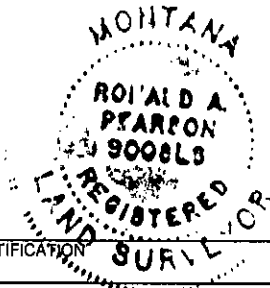

SKETCH OF CORNER

CERTIFICATION

I, Joe McElmurry
certify the information shown herein is true and correct.

I, Ronald A. Pearson
certify that this Corner Record correctly represents work performed by me or under my direction in compliance with the "Corner Recordation Act" (70-22-101, et seq., M.C.A.)

[Signature]
Signature of Surveyor & Seal

Date: 12/30/96

Reg. No.: 9008LS

Employer: U.S. FOREST SERVICE

Office of Clerk and Recorder, County of LINCOLN. This "corner record" was filed for record on FEB 2 1997 was noted on the cross-index plat and is assigned page No. 9045, in book No. _____

CORAL M. CUMMINGS
County Official *[Signature]*

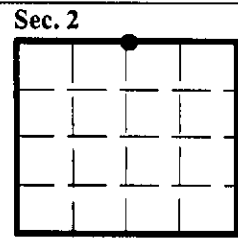

● - corner this sheet