

CERTIFIED CORNER RECORDATION

Corner C 1/4 Sec. 35 T. 30N R. 26W P.M., MT Lincoln County

- I. 1983 Certified Corner Recordation by William Condrey No. 5425 S: No original corner was ever set. Set by survey, for the center of section 35, a 30 in. long, 2 1/2 in. diam., aluminum post, 22 ins. in the ground, with a 3 in. diam. cap mkd. as shown:

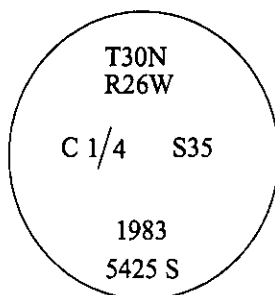

Established two bearing trees:

- A larch, 7 1/2 ins. diam., bears N79°E, 28.85 ft. dist., mkd. "C1/4 S35 BT".
A fir, 8 ins. diam., bears N76°W, 29.6 ft. dist., mkd. "C1/4 S35 BT".

Both bearing trees are on USFS property, monument is on the South slope, placed rock mound around the monument. Posted all signs in USFS property.

- II. Found a 2 1/2 in. diam. aluminum pipe, protruding 8 ins. above the ground, firmly set, in a small collar of stone, with a 3 1/4 in. diam. aluminum cap, mkd. as shown above.

rom which:

- A fallen larch, 8 ins. diam., bears N79°E, 28.8 ft. dist., mkd. with visible scribing. (1983-record)
A fir snag, 9 ins. diam., bears N69°W, 26.9 ft. dist., mkd. with visible scribing. (1983-record N76°W, 29.6 ft.)

- III. Established two new bearing trees.

- A larch, 18 ins. diam., bears N17°E, 24.0 ft. dist., mkd. "C1/4 S35 BT."
A larch, 15 ins. diam., bears S61°E, 52.0 ft. dist., mkd. "C1/4 S35 BT."

Set a 6 ft. steel guard post, South, 3.0 ft., with Land Survey Monument and Property Boundary decals.

Painted bearing trees and attached Land Survey Monument and Bearing Tree signs.

Magnetic Declination: 20° East.

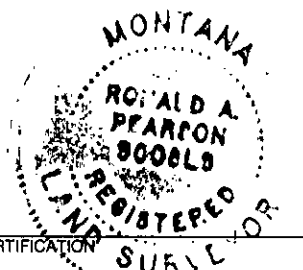

I, Rex O. Rice

certify the information shown herein is true and correct.

I, Ronald A. Pearson

certify that this Corner Record correctly represents work performed by me or under my direction in compliance with the "Corner Recordation Act" (70-22-101, et seq., M.C.A.)

[Signature]

Signature of Surveyor & Seal

Date: 12/30/96

Reg. No.: 9008LS

Employer: U.S. FOREST SERVICE

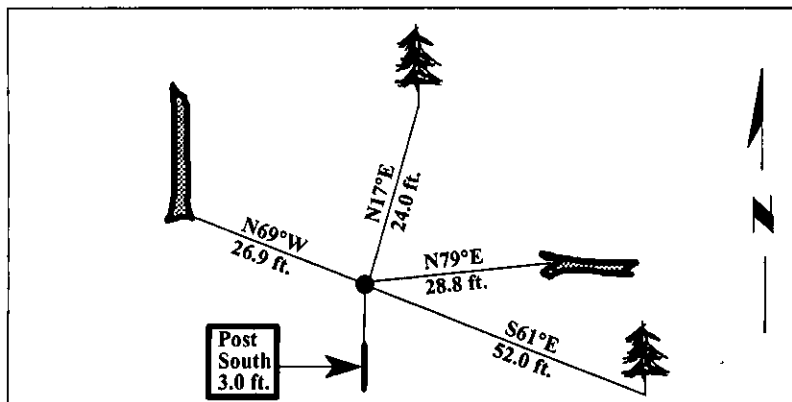

SKETCH OF CORNER

Office of Clerk and Recorder, County of LINCOLN. This "corner record" was filed for record on FEB 3, 1997 was noted on the cross-index plat and is assigned page No. 9044, in book No. CORAL M.C. MMINGS

County Official *[Signature]*

Sec. 35

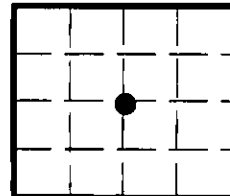

● - corner this sheet

Cross Index No. X-19 T. 30N R. 26W P.M., MT