

INSTRUCTIONS

1. Original and/or subsequent record used to evaluate the corner position.
2. Description of evidence found, note discrepancies in the record, state method of establishing lost or obliterated corners.
3. Description of monument and accessories set to perpetuate the corner position.
4. Sketch or corner, show all pertinent data which can best be shown in a sketch example, corner marking, topography ties, position of accessories, etc.
5. Certification must be signed and sealed by Registered Land Surveyor in State of Montana.
6. Fill in Cross Index & Section Diagram at bottom of sheet.

#62-82-5

CERTIFIED CORNER RECORDATION

Corner SE 1-16 Section 28 T. 30N R. 26W P.M.M. Lincoln County

I. No original record.

- II. At the corner position, set a 2½ x 30 inch pipe with a 3 inch aluminum cap marked as shown below, raised 3 ft. dia. mound of stones around the pipe, from which the following accessories:
- A fir, 12 inches dia., bears S63°W, 25.4 ft. dist. marked SE 1-16 BT.
- A tamarack, 9 ins. dia. bears N6°W, 30.7 ft. dist. marked SE 1-16 BT.
- Painted all blazes red, placed sign on BT's, set a fiberglass post alongside the monument and placed a location poster and survey monument sign on a nearby tree

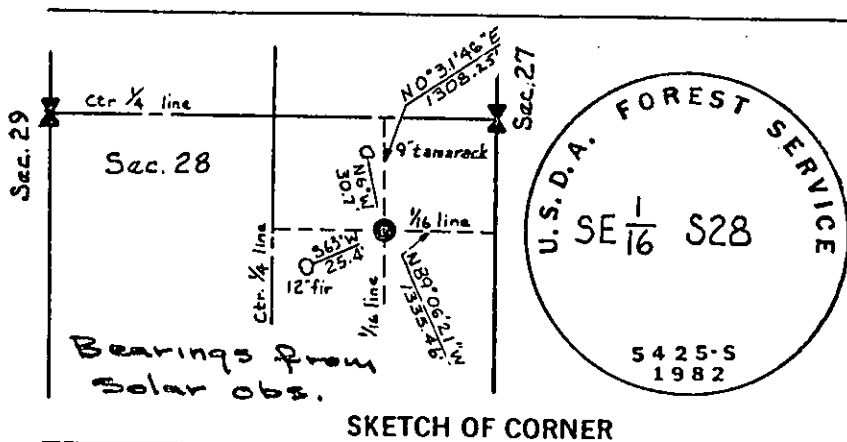

SKETCH OF CORNER

CERTIFICATION

I, _____, certify the information shown herein is true and correct.

Signature Ground Party Chief

William Condrey

I, _____, certify that this Corner Record correctly represents work performed by me or under my direction in compliance with the "Corner Recordation Act" (70-22 101, et seq., M.D.A.)

Signature of Surveyor & Seal

Date: 12-2-82 Reg. No. 5425S

Employer: Associated Surveys, Inc.

Office of Clerk and Recorder, County of Lincoln. This "corner record" was filed for record on the August 25th day of 1982 was noted on the cross-index plat and is assigned page No. 2327, in book No. _____

Janet BF Siegel by Betty L. Conner
County Official Deputy

Cross Index No. U-12 T. 30N R. 26W P.M.M.

Sec. 28

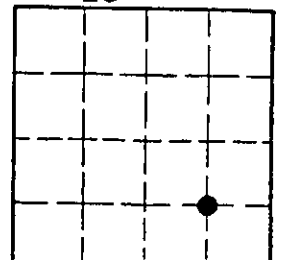

• - corner this sheet