

## INSTRUCTIONS

1. Original and/or subsequent record used to evaluate the corner position.
2. Description of evidence found, note discrepancies in the record, state method of establishing lost or obliterated corners.
3. Description of monument and accessories set to perpetuate the corner position.
4. Sketch of corner, show all pertinent data which can best be shown in a sketch example, corner marking, topography ties, position of accessories, etc.
5. Certification must be signed and sealed by Registered Land Surveyor in State of Montana.
6. Fill in Cross Index & Section Diagram at bottom of sheet.

#62-82-5

## CERTIFIED CORNER RECORDATION

Corner NE Corner Sec. 28 T. 30N R. 26W P.M.M. Lincoln County

- I. Set an iron post, 30 ins. long  $2\frac{1}{2}$  ins. diam., 24 ins. in the ground with BLM Brass Cap marked as shown below, from which:
- A pine, 7 ins. diam., bears N20.5°E, 34 lks. dist., marked T30N R26W S22 BT.
  - A pine 8 ins. dia., bears S9.75°E, 47 lks. dist. marked T30N R26W S27 BT.
  - A pine 7 ins. dia., bears S34°W, 47 lks. dist. marked T30N R26W S28 BT.
  - A pine 8 ins. dia., bears N57.5°W, 26 lks dist. marked T30N R26W S21 BT.
- Buried the original stone alongside and raised a flat mound of stone  $2\frac{1}{2}$ ' dia., around iron post.

- II. Found an iron post with BLM Brass Cap as described above, found four bearing trees. Painted corner and all blazes with red paint.

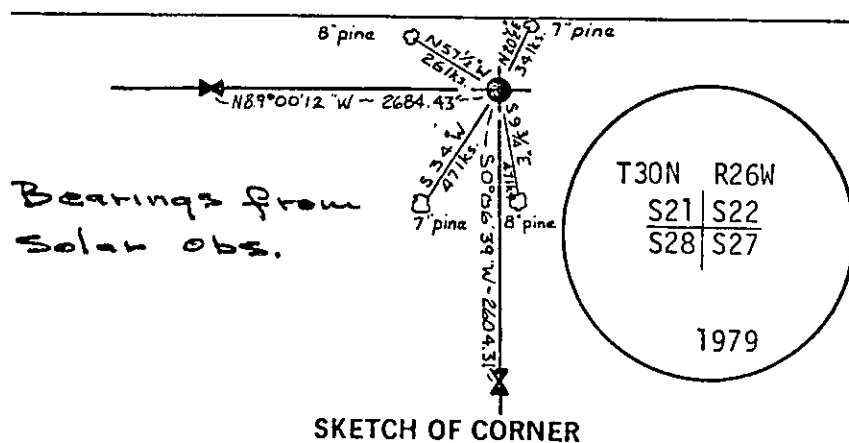

## CERTIFICATION

I, \_\_\_\_\_  
certify the information shown herein is true and correct.

Signature Ground Party Chief

I, William Condrey  
certify that this Corner Record correctly represents work performed by me or under by direction in compliance with the "Corner Recordation Act" (70-22-101, et seq., M.D.A.)

Signature of Surveyor & Seal

Date: 12-2-82 Reg. No. 54255

Employer: Associated Surveys, Inc.

Office of Clerk and Recorder, County of Lincoln. This "corner record" was filed for record on the August 25<sup>th</sup> day of 1983, was noted on the cross-index plat and is assigned page No. 2326, in book No. \_\_\_\_\_

Janet BF Siegel by Betty L. Conner  
County Official deputy

Cross Index No. R-13 T. 30N R. 26W P.M.M.

Sec. 28

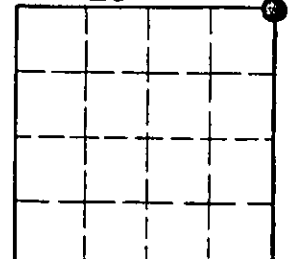

• corner this sheet